

Coupling Dimensional Specifications

The products described herein, including without limitation, product features, specifications, designs, availability and pricing, are subject to change by Perfecting Coupling Company and its subsidiaries at any time without notice.



Attention Required!

BR-Series Rectus '21' Interchange Couplings

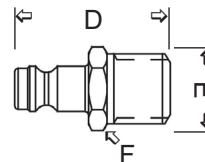
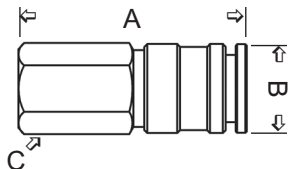

Body Size	End Size	Female NPT(F)	Female BSPP	Female ORB	Male NPT(F)	Male BSPT	Male ORB	Male JIC 37°	Hose Barb	Push-Loc Barb	Reusable Barb	Max. O.D.	Hex Size
Coupler		Dimension 'A'										'B'	'C'
1/8"	1/8"	39.4mm	39.4mm		37.8mm	37.8mm						16.0mm	9/16"
1/8"	1/4"	45.0mm	45.0mm		40.9mm	40.9mm						16.0mm	9/16"
Nipple		Dimension 'D'										'E'	'F'
1/8"	1/8"	29.0mm	29.0mm		26.9mm	26.9mm			32.0mm			8.9mm	9/16"
1/8"	1/4"	33.8mm	45.0mm		30.5mm	30.5mm			32.0mm			8.9mm	9/16"
1/8"	3/8"	-	-		-	-			32.0mm			8.9mm	-

U-Series Universal Pneumatic Interchange

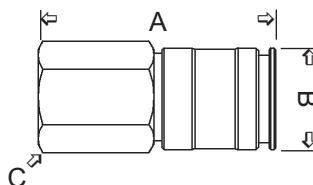

Body Size	End Size	Female NPT(F)	Female BSPP	Female ORB	Male NPT(F)	Male BSPT	Male ORB	Male JIC 37°	Hose Barb	Push-Loc Barb	Reusable Barb	Max. O.D.	Hex Size
Coupler		Dimension 'A'										'B'	'C'
1/4"	1/4"	59.0mm	59.0mm		62.0mm	62.0mm			67.0mm	64.0mm		23.4mm	3/4"
1/4"	5/16"	-	-		-	-			69.5mm	-		23.4mm	-
1/4"	3/8"	59.0mm	-		62.0mm	-			70.0mm	67.0mm		23.4mm	3/4"
3/8"	3/8"	64.5mm	64.5mm		67.0mm	67.0mm			77.5mm	-		27.7mm	15/16"
3/8"	1/2"	68.0mm	-		70.0mm	-			76.0mm	-		27.7mm	15/16"

L-Series Lincoln 'Long-Stem' Interchange

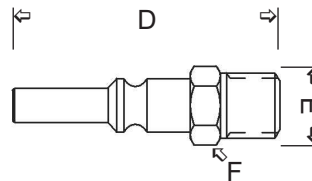
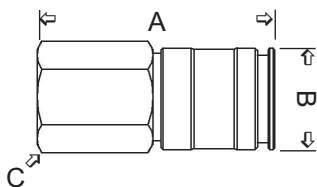

Body Size	End Size	Female NPT(F)	Female BSPP	Female ORB	Male NPT(F)	Male BSPT	Male ORB	Male JIC 37°	Hose Barb	Push-Loc Barb	Reusable Barb	Max. O.D.	Hex Size
Coupler		Dimension 'A'										'B'	'C'
1/4"	1/4"	59.0mm			62.0mm							23.4mm	3/4"
Nipple		Dimension 'D'										'E'	'F'
1/4"	1/4"	53.3mm			57.2mm							18.3mm	9/16"

DF-Series Industrial Interchange

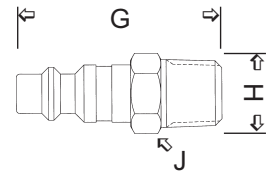
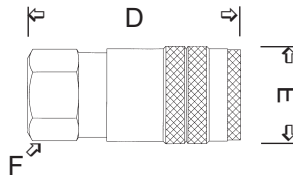
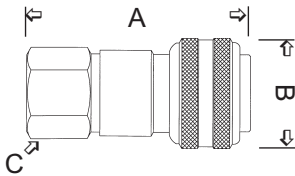

Body Size	End Size	Female NPT(F)	Female BSPP	Female ORB	Male NPT(F)	Male BSPT	Male ORB	Male JIC 37°	Hose Barb	Push-Loc Barb	Reusable Barb	Max. O.D.	Hex Size
'D' Coupler		Dimension 'A'							'B'	'C'			
1/4"	1/8"	51.8mm	-	-	56.1mm	-	-	-	-	-	-	24.9mm	11/16"
1/4"	1/4"	56.1mm	56.1mm	-	59.4mm	59.4mm	-	-	73.7mm	70.1mm	70.9mm	24.9mm	11/16"
1/4"	5/16"	-	-	-	-	-	-	-	73.7mm	-	-	24.9mm	-
1/4"	3/8"	60.5mm	60.5mm	-	59.9mm	59.9mm	-	-	73.7mm	70.4mm	72.4mm	24.9mm	13/16"
3/8"	1/4"	61.0mm	-	-	65.8mm	-	-	-	76.2mm	-	-	30.0mm	7/8"
3/8"	3/8"	64.0mm	64.0mm	-	69.3mm	69.3mm	-	-	76.3mm	71.7mm	-	30.0mm	7/8"
3/8"	1/2"	71.1mm	-	-	74.7mm	-	-	-	76.3mm	-	-	30.0mm	1"
1/2"	3/8"	75.9mm	-	-	79.5mm	-	-	-	89.2mm	-	-	34.0mm	1-1/16"
1/2"	1/2"	85.3mm	85.3mm	-	80.5mm	80.5mm	-	-	89.2mm	84.1mm	-	34.0mm	1-1/16"
1/2"	3/4"	86.6mm	-	-	82.0mm	-	-	-	89.2mm	-	-	34.0mm	1-3/16"
3/4"	1/2"	74.9mm	-	-	74.9mm	-	-	-	93.7mm	-	-	48.3mm	1-3/16"
3/4"	3/4"	75.9mm	-	-	74.9mm	-	-	-	93.7mm	-	-	48.3mm	1-5/16"
3/4"	1"	80.8mm	-	-	79.2mm	-	-	-	99.8mm	-	-	48.3mm	1-9/16"

D-Series Automatic Safety Exhausting Coupler Operation

The D-Series Automatic coupling has been performing reliably and safely for over 50-years. This amazing coupler is an inexpensive solution for automatically connecting pressurized air lines and is the only one-handed single-stage exhausting safety coupler available in the market today!

Most exhausting safety couplers are a two stage system that are expensive and difficult to operate. Why pay extra for safety? Use the D-Series Automatic Safety Exhausting Couplers, available in sizes 1/4" to 3/4". (Page 12)



① To disconnect, begin by holding the hose on the nipple side with three of your fingers, leaving your thumb and index finger free.



② Grab the sleeve with your thumb and index finger and begin to pull the sleeve towards the palm of your hand.



③ After pulling the sleeve, the nipple will move out of the coupler slightly. Continue to hold the hose and coupler sleeve until all air is fully exhausted.

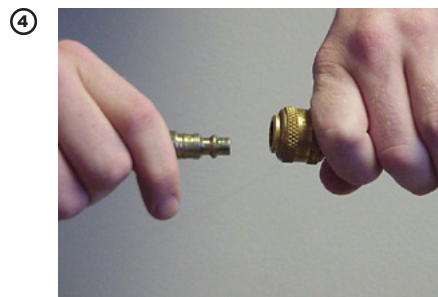

④ After the line is fully exhausted, you are able to safely separate the nipple from the coupler.

Body Size	End Size	Female NPT(F)	Female BSPP	Female ORB	Male NPT(F)	Male BSPT	Male ORB	Male JIC 37°	Hose Barb	Push-Loc Barb	Reusable Barb	Max. O.D.	Hex Size
'F' Coupler		Dimension 'D'										'E'	'F'
1/4"	1/8"	46.5mm	46.5mm	-	50.0mm	-	-	-	64.3mm	-	-	22.4mm	3/4"
1/4"	1/4"	51.8mm	51.8mm	-	51.8mm	51.8mm	-	-	64.3mm	58.9mm	61.7mm	22.4mm	3/4"
1/4"	5/16"	-	-	-	-	-	-	-	64.3mm	-	-	22.4mm	3/4"
1/4"	3/8"	54.4mm	-	-	52.8mm	-	-	-	72.6mm	58.9mm	63.8mm	22.4mm	13/16"
3/8"	1/4"	57.2mm	-	-	62.2mm	-	-	-	72.6mm	-	-	26.9mm	7/8"
3/8"	3/8"	63.0mm	63.0mm	-	62.5mm	62.5mm	-	-	72.6mm	73.2mm	-	26.9mm	7/8"
3/8"	1/2"	66.3mm	-	-	63.5mm	-	-	-	88.7mm	-	-	26.9mm	1"
1/2"	3/8"	73.7mm	-	-	75.4mm	-	-	-	88.7mm	-	-	30.2mm	1"
1/2"	1/2"	77.2mm	77.2mm	-	78.0mm	78.0mm	-	-	88.7mm	87.9mm	-	30.2mm	1"
1/2"	3/4"	79.8mm	-	-	79.3mm	-	-	-	88.7mm	-	-	30.2mm	1-3/16"
Nipple		Dimension 'G'										'H'	'J'
1/4"	1/8"	36.6mm	-	-	39.9mm	-	-	-	-	-	-	16.5mm	9/16"
1/4"	1/4"	42.2mm	42.2mm	-	42.9mm	42.9mm	-	-	53.1mm	53.1mm	54.9mm	20.1mm	11/16"
1/4"	5/16"	-	-	-	-	-	-	-	53.1mm	-	-	20.1mm	-
1/4"	3/8"	42.2mm	42.2mm	-	44.5mm	44.5mm	-	-	53.1mm	53.1mm	55.4mm	25.7mm	7/8"
3/8"	1/4"	45.2mm	-	-	46.0mm	-	-	-	56.1mm	-	-	20.1mm	11/16"
3/8"	3/8"	45.2mm	45.2mm	-	47.5mm	47.5mm	-	-	56.1mm	55.1mm	-	25.7mm	7/8"
3/8"	1/2"	49.3mm	-	-	51.6mm	-	-	-	56.1mm	-	-	29.5mm	1"
1/2"	3/8"	53.3mm	-	-	55.6mm	-	-	-	64.3mm	-	-	25.7mm	7/8"
1/2"	1/2"	57.1mm	57.1mm	-	59.4mm	59.4mm	-	-	64.3mm	67.6mm	-	29.5mm	1"
1/2"	3/4"	58.4mm	-	-	63.5mm	-	-	-	64.3mm	-	-	34.8mm	1-3/16"
3/4"	1/2"	56.4mm	-	-	60.5mm	-	-	-	76.2mm	-	-	38.6mm	1-5/16"
3/4"	3/4"	56.4mm	-	-	60.5mm	-	-	-	76.2mm	-	-	38.6mm	1-5/16"
3/4"	1"	61.2mm	-	-	65.0mm	-	-	-	82.3mm	-	-	45.7mm	1-9/16"

CJ-Series European High Flow Interchange

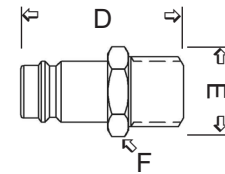
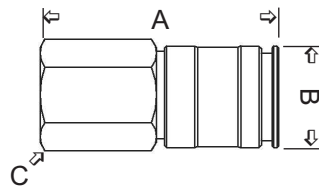

Body Size	End Size	Female NPT(F)	Female BSPP	Female ORB	Male NPT(F)	Male BSPT	Male ORB	Male JIC 37°	Hose Barb	Push-Loc Barb	Reusable Barb	Max. O.D.	Hex Size
Coupler		Dimension 'A'										'B'	'C'
1/4"	1/4"	59.0mm	59.0mm	-	62.0mm	62.0mm	-	-	67.0mm	64.0mm	-	23.4mm	3/4"
1/4"	3/8"	59.0mm	59.0mm	-	62.0mm	62.0mm	-	-	70.0mm	-	-	23.4mm	3/4"
3/8"	3/8"	64.5mm	64.5mm	-	67.0mm	67.0mm	-	-	77.5mm	67.0mm	-	27.7mm	15/16"
3/8"	1/2"	68.0mm	68.0mm	-	70.0mm	70.0mm	-	-	76.0mm	-	-	27.7mm	15/16"
Nipple		Dimension 'D'										'E'	'F'
1/4"	1/4"	37.5mm	36.0mm	-	37.5mm	37.5mm	-	-	41.5mm	37.0mm	-	16.2mm	9/16"
1/4"	5/16"	-	-	-	-	-	-	-	44.5mm	-	-	13.0mm	-
1/4"	3/8"	39.5mm	37.5mm	-	39.5mm	39.5mm	-	-	44.5mm	39.5mm	-	19.6mm	11/16"
3/8"	3/8"	37.0mm	38.0mm	-	40.0mm	40.0mm	-	-	45.5mm	-	-	23.1mm	13/16"
3/8"	1/2"	42.0mm	43.5mm	-	46.0mm	46.0mm	-	-	45.0mm	-	-	31.2mm	1-1/16"

CL-Series 'PCL' Interchange

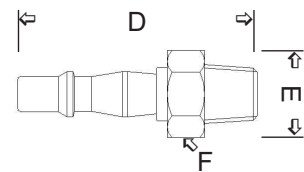
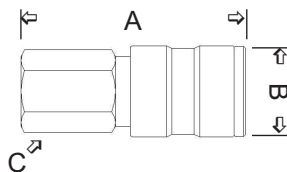

Body Size	End Size	Female NPT(F)	Female BSPP	Female ORB	Male NPT(F)	Male BSPT	Male ORB	Male JIC 37°	Hose Barb	Push-Loc Barb	Reusable Barb	Max. O.D.	Hex Size
Coupler		Dimension 'A'										'B'	'C'
1/4"	1/4"	-	60.0mm	-	-	60.0mm	-	-	-	-	-	24.0mm	3/4"
1/4"	3/8"	-	60.0mm	-	-	61.0mm	-	-	-	-	-	24.0mm	3/4"
Nipple		Dimension 'D'										'E'	'F'
1/4"	1/4"	-	51.1mm	-	-	54.0mm	-	-	53.7mm	-	-	7.9mm	3/4"
1/4"	3/8"	-	52.0mm	-	-	55.0mm	-	-	55.0mm	-	-	7.9mm	3/4"

J-Series Truflate Automotive Interchange

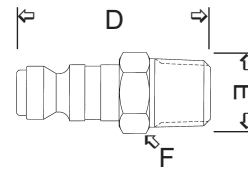
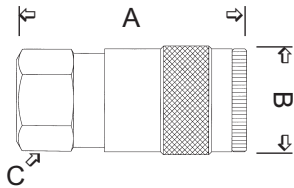

Body Size	End Size	Female NPT(F)	Female BSPP	Female ORB	Male NPT(F)	Male BSPT	Male ORB	Male JIC 37°	Hose Barb	Push-Loc Barb	Reusable Barb	Max. O.D.	Hex Size
Coupler		Dimension 'A'										'B'	'C'
1/4"	1/8"	46.5mm	-	-	47.8mm	-	-	-	-	-	-	22.4mm	3/4"
1/4"	1/4"	51.8mm	51.8mm	-	51.8mm	-	-	-	64.3mm	60.2mm	63.8mm	22.4mm	3/4"
1/4"	5/16"	-	-	-	-	-	-	-	64.3mm	-	-	22.4mm	3/8"
1/4"	3/8"	54.4mm	-	-	52.8mm	-	-	-	64.3mm	63.3mm	65.3mm	22.4mm	13/16"
3/8"	1/4"	57.2mm	-	-	62.2mm	-	-	-	72.6mm	-	-	26.9mm	7/8"
3/8"	3/8"	63.0mm	63.0mm	-	62.5mm	-	-	-	72.6mm	70.9mm	-	26.9mm	7/8"
3/8"	1/2"	66.3mm	-	-	64.8mm	-	-	-	72.6mm	-	-	26.9mm	1"
1/2"	3/8"	73.7mm	-	-	75.4mm	-	-	-	88.7mm	-	-	30.2mm	1"
1/2"	1/2"	77.2mm	77.2mm	-	78.0mm	-	-	-	88.7mm	86.5mm	-	30.2mm	1"
1/2"	3/4"	79.8mm	-	-	79.3mm	-	-	-	88.7mm	-	-	30.2mm	1-3/16"
Nipple		Dimension 'D'										'E'	'F'
1/4"	1/8"	34.0mm	-	-	37.3mm	-	-	-	-	-	-	16.5mm	9/16"
1/4"	1/4"	39.6mm	39.6mm	-	40.4mm	-	-	-	50.6mm	50.6mm	52.6mm	20.1mm	11/16"
1/4"	5/16"	-	-	-	-	-	-	-	50.6mm	-	-	20.1mm	-
1/4"	3/8"	39.6mm	-	-	41.9mm	-	-	-	50.6mm	50.6mm	53.3mm	25.7mm	7/8"
3/8"	1/4"	44.5mm	-	-	45.2mm	-	-	-	55.4mm	-	-	20.1mm	11/16"
3/8"	3/8"	44.5mm	44.5mm	-	46.7mm	-	-	-	55.4mm	54.9mm	-	25.7mm	7/8"
3/8"	1/2"	48.5mm	-	-	50.8mm	-	-	-	55.4mm	-	-	29.5mm	1"
1/2"	3/8"	53.6mm	-	-	55.9mm	-	-	-	64.5mm	-	-	25.7mm	7/8"
1/2"	1/2"	57.4mm	77.2mm	-	59.7mm	-	-	-	64.5mm	67.6mm	-	29.5mm	1"
1/2"	3/4"	58.7mm	-	-	63.8mm	-	-	-	64.5mm	-	-	34.8mm	1-3/16"

M-Series ARO 210/310 Interchange

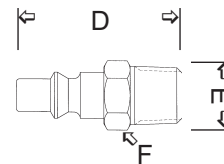
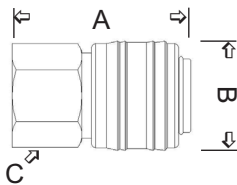

Body Size	End Size	Female NPT(F)	Female BSPP	Female ORB	Male NPT(F)	Male BSPT	Male ORB	Male JIC 37°	Hose Barb	Push-Loc Barb	Reusable Barb	Max. O.D.	Hex Size
Auto Coupler		Dimension 'A'										'B'	'C'
1/4"	1/4"	43.6mm	51.8mm	-	43.2mm	-	-	-	48.6mm	-	-	27.0mm	22.0mm
1/4"	5/16"	-	-	-	-	-	-	-	59.1mm	-	-	27.0mm	22.0mm
1/4"	3/8"	43.6mm	-	-	45.6mm	-	-	-	63.6mm	-	-	27.0mm	22.0mm
3/8"	3/8"	49.0mm	63.0mm	-	48.0mm	-	-	-	66.0mm	-	-	32.0mm	27.0mm
3/8"	1/2"	52.0mm	-	-	50.0mm	-	-	-	66.0mm	-	-	32.0mm	27.0mm
Man. Coupler		Dimension 'A'										'B'	'C'
1/4"	1/4"	50.0mm	-	-	54.0mm	-	-	-	60.0mm	-	-	22.0mm	19.0mm
1/4"	5/16"	-	-	-	-	-	-	-	65.0mm	-	-	22.0mm	19.0mm
1/4"	3/8"	52.0mm	-	-	54.0mm	-	-	-	70.0mm	-	-	22.0mm	21.0mm
Nipple		Dimension 'D'										'E'	'F'
1/4"	1/8"	-	-	-	37.4mm	-	-	-	-	-	-	16.5mm	9/16"
1/4"	1/4"	39.6mm	39.6mm	-	40.4mm	-	-	-	50.5mm	-	-	20.1mm	11/16"
1/4"	5/16"	-	-	-	-	-	-	-	50.5mm	-	-	20.1mm	-
1/4"	3/8"	39.6mm	-	-	41.9mm	-	-	-	50.5mm	-	-	25.7mm	7/8"
3/8"	3/8"	44.5mm	44.5mm	-	46.7mm	-	-	-	55.4mm	-	-	25.7mm	7/8"
3/8"	1/2"	-	-	-	-	-	-	-	55.4mm	-	-	29.5mm	1"

SHD-Series Schrader/Rectus '17' Interchange

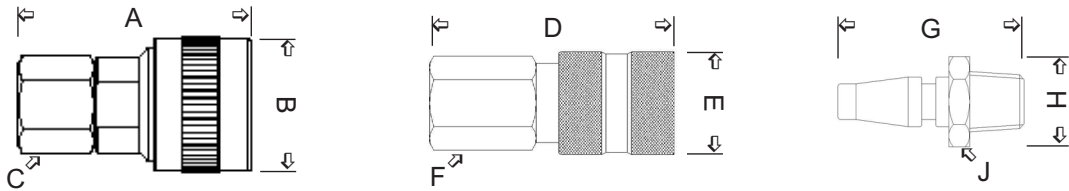

Body Size	End Size	Female NPT(F)	Female BSPP	Female ORB	Male NPT(F)	Male BSPT	Male ORB	Male JIC 37°	Hose Barb	Push-Loc Barb	Reusable Barb	Max. O.D.	Hex Size	
TL Coupler												Dimension 'A'	'B'	'C'
1/4"	1/4"	53.3mm			56.4mm				64.5mm			28.4mm	11/16"	
1/4"	3/8"	55.4mm			57.9mm				67.8mm			28.4mm	11/16"	
1/2"	3/8"	65.8mm			64.8mm				76.0mm			38.1mm	1-1/8"	
1/2"	1/2"	67.6mm			66.3mm				107.4mm			38.1mm	1-1/8"	
1/2"	3/4"	71.4mm			-				-			38.1mm	1-1/8"	
Auto Coupler												Dimension 'D'	'E'	'F'
1/4"	1/4"	51.0mm	51.0mm		53.0mm	53.0mm			60.0mm			22.0mm	17.0mm	
1/4"	3/8"	-	-		-	-			65.0mm			22.0mm	17.0mm	
Nipple												Dimension 'G'	'H'	'J'
1/4"	1/8"	37.9mm	-		39.1mm	-			-			16.5mm	11/16"	
1/4"	1/4"	41.2mm	41.2mm		43.7mm	43.7mm			51.6mm			16.5mm	11/16"	
1/4"	3/8"	-	-		-	-			56.4mm			16.5mm	11/16"	
1/2"	1/4"	-	-		46.0mm	-			-			20.3mm	7/8"	
1/2"	3/8"	45.5mm	-		47.5mm	-			59.4mm			20.3mm	7/8"	
1/2"	1/2"	-	-		51.6mm	-			64.3mm			20.3mm	7/8"	

SCV-Series Excessive Flow Sensor/Check Valve

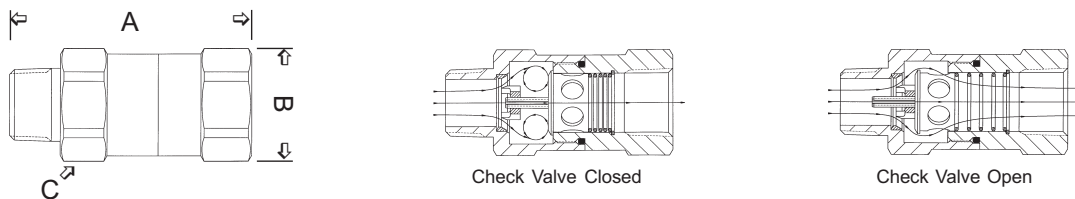

Body Size	End Size	Female NPT(F)	Female BSPP	Female ORB	Male NPT(F)	Male BSPT	Male ORB	Male JIC 37°	Hose Barb	Push-Loc Barb	Reusable Barb	Max. O.D.	Hex Size	
SCV-Series Excessive Flow Sensor/Check Valve												Dimension 'A'	'B'	'C'
1/4"	1/4"	55.6mm	55.6mm									22.1mm	3/4"	
3/8"	3/8"	62.0mm	62.0mm									29.5mm	1"	
1/2"	1/2"	73.9mm	73.9mm									33.0mm	1-1/8"	
3/4"	3/4"	90.4mm	90.4mm									43.9mm	1-1/2"	
1"	1"	108.7mm	108.7mm									55.1mm	1-7/8"	
1-1/4"	1-1/4"	114.3mm	114.3mm									66.0mm	2-1/4"	
1-1/2"	1-1/2"	138.9mm	138.9mm									80.0mm	2-7/8"	
2"	2"	159.5mm	159.5mm									102.6mm	3-1/2"	
3"	3"	228.6mm	228.6mm									153.9mm	5-1/4"	

N-Series Bowes Interchange

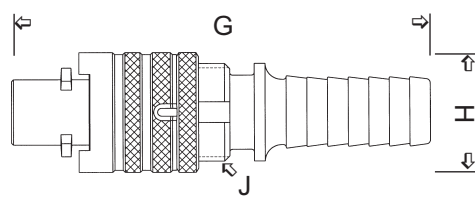
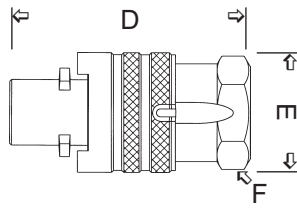
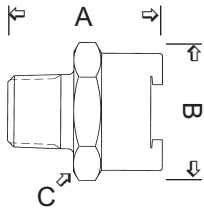

Body Size	End Size	Female NPT(F)	Female BSPP	Female ORB	Male NPT(F)	Male BSPT	Male ORB	Male JIC 37°	Hose Barb	Push-Loc Barb	Reusable Barb	Max. O.D.	Hex Size
Coupler		Dimension 'A'										'B'	'C'
3/8"	1/2"	-	-	-	43.6mm	43.6mm	-	-	61.2mm	-	-	30.5mm	1-3/16"
1/2"	3/8"	41.4mm	41.4mm	-	45.0mm	45.0mm	-	-	75.7mm	-	-	39.1mm	1-3/8"
1/2"	1/2"	41.4mm	41.4mm	-	45.0mm	45.0mm	-	-	85.6mm	-	-	39.1mm	1-3/8"
1/2"	3/4"	41.4mm	41.4mm	-	45.0mm	45.0mm	-	-	85.6mm	-	-	39.1mm	1-3/8"
1/2"	1"	42.6mm	42.6mm	-	46.8mm	46.8mm	-	-	88.7mm	-	-	39.1mm	1-1/2"
1-1/4"	1"	50.6mm	-	-	57.5mm	-	-	-	-	-	-	52.0mm	2"
1-1/4"	1-1/4"	52.8mm	-	-	60.0mm	-	-	-	-	-	-	52.0mm	2"
Valve Coupler		Dimension 'A'										'B'	'C'
1/2"	3/4"	63.5mm	63.5mm	-	67.0mm	-	-	-	-	-	-	38.1mm	1-1/2"
Nipple		Dimension 'D'										'E'	'F'
3/8"	1/2"	-	-	-	83.2mm	83.2mm	-	-	94.8mm	-	-	28.6mm	1-1/8"
1/2"	3/8"	69.3mm	69.3mm	-	92.7mm	92.7mm	-	-	110.7mm	-	-	35.6mm	1-1/8"
1/2"	1/2"	69.3mm	69.3mm	-	92.7mm	92.7mm	-	-	117.6mm	-	-	35.6mm	1-1/8"
1/2"	3/4"	84.8mm	84.8mm	-	95.0mm	95.0mm	-	-	121.2mm	-	-	35.6mm	1-3/8"
1/2"	1"	85.7mm	85.7mm	-	95.9mm	95.9mm	-	-	121.2mm	-	-	35.6mm	1-1/2"
1-1/4"	1"	87.5mm	-	-	114.3mm	-	-	-	-	-	-	50.7mm	1-3/4"
1-1/4"	1-1/4"	89.6mm	-	-	118.6mm	-	-	-	-	-	-	50.7mm	2"
Safety Nipple		Dimension 'G'										'H'	'J'
1/2"	1/2"	-	-	-	108.6mm	108.6mm	-	-	137.1mm	-	-	35.6mm	1-1/2"
1/2"	3/4"	-	-	-	111.2mm	111.2mm	-	-	144.7mm	-	-	35.6mm	1-3/8"

P-Series Thor Interchange

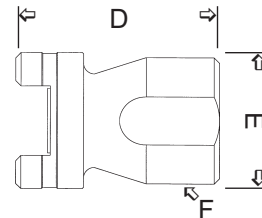
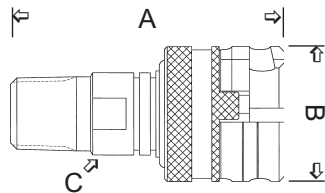

Body Size	End Size	Female NPT(F)	Female BSPP	Female ORB	Male NPT(F)	Male BSPT	Male ORB	Male JIC 37°	Hose Barb	Push-Loc Barb	Reusable Barb	Max. O.D.	Hex Size
Coupler		Dimension 'A'										'B'	'C'
1/2"	3/8"	-	-	-	74.4mm	-	-	-	89.7mm	-	-	39.4mm	1-3/8"
1/2"	1/2"	87.1mm	-	-	79.0mm	-	-	-	100.3mm	-	-	39.4mm	1-3/8"
1/2"	3/4"	87.1mm	-	-	79.5mm	-	-	-	100.3mm	-	-	39.4mm	1-3/8"
1/2"	1"	-	-	-	-	-	-	-	153.9mm	-	-	39.4mm	-
Nipple		Dimension 'D'										'E'	'F'
1/2"	3/8"	45.5mm	-	-	50.8mm	-	-	-	-	-	-	39.4mm	7/8"
1/2"	1/2"	57.2mm	-	-	57.2mm	-	-	-	-	-	-	39.4mm	1-3/8"
1/2"	3/4"	59.4mm	-	-	64.8mm	-	-	-	-	-	-	39.4mm	1-5/16"
1/2"	1"	70.0mm	-	-	82.6mm	-	-	-	-	-	-	39.4mm	1-15/32"

B-Series Astronautic Miniature Couplings



Body Size	End Size	Female NPT(F)	Female BSPP	Female ORB	Male NPT(F)	Male BSPT	Male ORB	Male JIC 37°	Hose Barb	Push-Loc Barb	Reusable Barb	Max. O.D.	Hex Size
Coupler		Dimension 'A'										'B'	'C'
1/8"	1/8"				34.0mm							16.0mm	9/16"
Nipple		Dimension 'D'										'E'	-
1/8"	1/8"							44.5mm				14.0mm	

A-Series Astronautic Couplings



Body Size	End Size	Female NPT(F)	Female BSPP	Female ORB	Male NPT(F)	Male BSPT	Male ORB	Male JIC 37°	Hose Barb	Push-Loc Barb	Reusable Barb	Max. O.D.	Hex Size
Coupler		Dimension 'A'										'B'	'C'
1/8"	1/8"	42.7mm			44.5mm				50.3mm			16.3mm	1/2"
1/4"	1/8"	49.3mm			53.8mm				61.2mm			23.1mm	13/16"
1/4"	1/4"	53.6mm			56.6mm				68.6mm	66.5mm		23.1mm	13/16"
Nipple		Dimension 'D'										'E'	'F'
1/8"	1/8"	32.0mm			33.0mm				38.1mm			14.7mm	1/2"
1/4"	1/8"	34.0mm			37.3mm				43.2mm			25.7mm	7/8"
1/4"	3/16"	-			-				43.2mm			25.7mm	7/8"
1/4"	1/4"	39.6mm			40.4mm				50.5mm	50.0mm		25.7mm	7/8"

1058-Series Heavy Duty Pneumatic/Steam



Body Size	End Size	Female NPT(F)	Female BSPP	Female ORB	Male NPT(F)	Male BSPT	Male ORB	Male JIC 37°	Hose Barb	Push-Loc Barb	Reusable Barb	Max. O.D.	Hex Size
Coupler		Dimension 'A'										'B'	'C'
3/4"	3/4"	64.4mm			79.5mm							50.5mm	1-1/4"
Nipple		Dimension 'D'										'E'	'F'
3/4"	3/4"	45.5mm										38.4mm	1-3/8"

H-Series ISO7241 Series 'B' Interchange

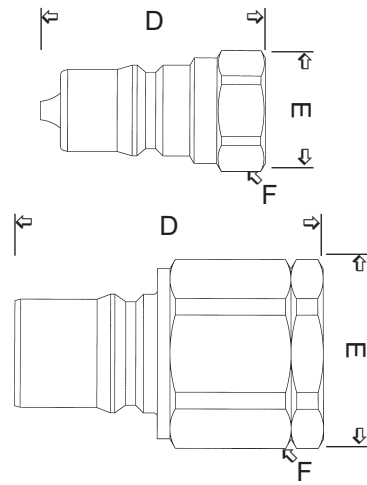
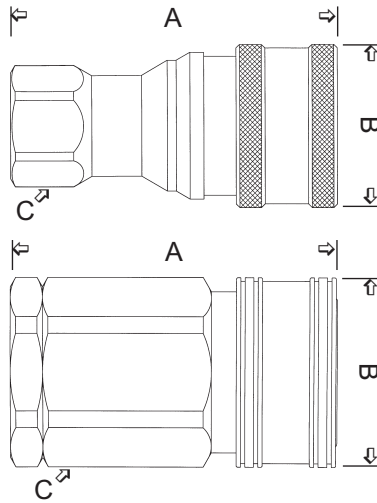

Body Size	End Size	Female NPT(F)	Female BSPP	Female ORB	Male NPT(F)	Male BSPT	Male ORB	Male JIC 37°	Hose Barb	Push-Loc Barb	Reusable Barb	Max. O.D.	Hex Size	
Coupler												Dimension 'A'	'B'	'C'
1/8"	1/8"	48.3mm	48.3mm	-	-	-	-	-	-	-	-	23.6mm	9/16"	
1/8"	1/4"	-	-	48.3mm	-	-	-	-	-	-	-	23.6mm	9/16"	
1/8"	3/8"	-	-	-	-	-	-	-	-	-	-	-	-	
1/4"	1/4"	57.4mm	57.4mm	-	-	-	-	-	-	-	-	28.5mm	3/4"	
1/4"	3/8"	-	-	57.4mm	-	-	-	-	-	-	-	28.5mm	13/16"	
3/8"	3/8"	63.8mm	63.8mm	-	-	-	-	-	-	-	-	36.1mm	7/8"	
3/8"	1/2"	-	-	63.8mm	-	-	-	-	-	-	-	36.1mm	1"	
1/2"	1/2"	72.6mm	72.6mm	-	-	-	-	-	-	-	-	47.2mm	1-1/16"	
1/2"	5/8"	-	-	72.6mm	-	-	-	-	-	-	-	47.2mm	1-1/8"	
3/4"	3/4"	90.2mm	90.2mm	90.2mm	-	-	-	-	-	-	-	56.4mm	1-5/16"	
1"	1"	104.9mm	104.9mm	104.9mm	-	-	-	-	-	-	-	63.3mm	1-5/8"	
1-1/4"	1-1/4"	114.3mm	114.3mm	114.3mm	-	-	-	-	-	-	-	66.0mm	2-3/8"	
1-1/2"	1-1/2"	122.2mm	122.2mm	122.2mm	-	-	-	-	-	-	-	76.2mm	2-5/8"	
Nipple												Dimension 'D'	'E'	'F'
1/8"	1/8"	32.5mm	32.5mm	-	-	-	-	-	-	-	-	16.5mm	9/16"	
1/8"	1/4"	-	-	32.5mm	32.5mm	-	-	-	-	-	-	16.5mm	9/16"	
1/8"	3/8"	-	-	-	-	-	32.5mm	-	-	-	-	16.5mm	9/16"	
1/4"	1/4"	39.4mm	39.4mm	-	-	-	-	-	-	-	-	22.9mm	3/4"	
1/4"	3/8"	-	-	41.0mm	41.0mm	-	-	-	-	-	-	24.6mm	13/16"	
3/8"	3/8"	43.2mm	43.2mm	-	-	-	-	-	-	-	-	24.6mm	7/8"	
3/8"	1/2"	-	-	45.5mm	-	-	-	-	-	-	-	27.9mm	1"	
1/2"	1/2"	49.3mm	49.2mm	-	-	-	-	-	-	-	-	29.7mm	1-1/16"	
1/2"	5/8"	-	-	49.3mm	-	-	-	-	-	-	-	31.5mm	1-1/8"	
3/4"	3/4"	61.2mm	61.2mm	61.2mm	-	-	-	-	-	-	-	36.6mm	1-5/16"	
1"	1"	72.9mm	72.9mm	72.9mm	-	-	-	-	-	-	-	45.5mm	1-5/8"	
1-1/4"	1-1/4"	108.0mm	108.0mm	108.0mm	-	-	-	-	-	-	-	66.0mm	2-3/8"	
1-1/2"	1-1/2"	120.9mm	120.9mm	120.9mm	-	-	-	-	-	-	-	73.2mm	2-5/8"	

GT-Series Snap-Tite '23' Interchange

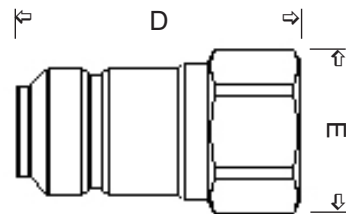
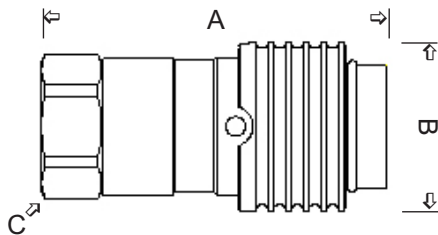

Body Size	End Size	Female NPT(F)	Female BSPP	Female ORB	Male NPT(F)	Male BSPT	Male ORB	Male JIC 37°	Hose Barb	Push-Loc Barb	Reusable Barb	Max. O.D.	Hex Size	
Coupler												Dimension 'A'	'B'	'C'
3/8"	3/8"	1/8"	1/8"	1/8"	1/8"	1/8"	1/8"	1/8"	1/8"	1/8"	1/8"	1/8"	1/8"	
Nipple												Dimension 'D'	'E'	'F'
3/8"	3/8"	1/8"	1/8"	1/8"	1/8"	1/8"	1/8"	1/8"	1/8"	1/8"	1/8"	1/8"	1/8"	

H-Series ISO7241 Series 'B' Steam Interchange

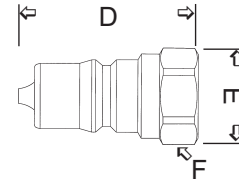
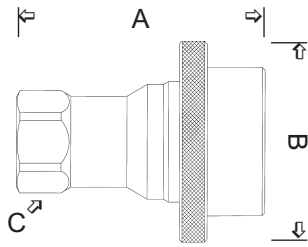

Body Size	End Size	Female NPT(F)	Female BSPP	Female ORB	Male NPT(F)	Male BSPT	Male ORB	Male JIC 37°	Hose Barb	Push-Loc Barb	Reusable Barb	Max. O.D.	Hex Size		
Coupler												Dimension 'A'		'B'	'C'
1/4"	1/4"	57.4mm	57.4mm									36.1mm	3/4"		
3/8"	3/8"	63.8mm	63.8mm									43.9mm	7/8"		
1/2"	1/2"	72.6mm	72.6mm									58.2mm	1-1/16"		
3/4"	3/4"	90.2mm	90.2mm									66.3mm	1-5/16"		
1"	1"	104.9mm	104.9mm									75.7mm	1-5/8"		
Coupler												Dimension 'D'		'E'	'F'
1/4"	1/4"	39.4mm	39.4mm									21.1mm	3/4"		
3/8"	3/8"	43.2mm	43.2mm									24.6mm	7/8"		
1/2"	1/2"	49.3mm	49.3mm									29.7mm	1-1/16"		
3/4"	3/4"	61.2mm	61.2mm									36.6mm	1-5/16"		
1"	1"	72.9mm	72.9mm									45.7mm	1-5/8"		

T-Series High Pressure Screw-Together

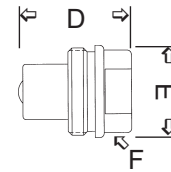
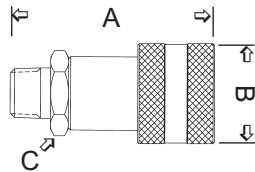

Body Size	End Size	Female NPT(F)	Female BSPP	Female ORB	Male NPT(F)	Male BSPT	Male ORB	Male JIC 37°	Hose Barb	Push-Loc Barb	Reusable Barb	Max. O.D.	Hex Size		
Coupler												Dimension 'A'		'B'	'C'
1/4"	1/4"	-			59.9mm	59.9mm						29.0mm	13/16"		
3/8"	3/8"	71.9mm			71.9mm	71.9mm						35.3mm	1"		
Nipple												Dimension 'D'		'E'	'F'
1/4"	1/4"	33.0mm	33.0mm									28.5mm	3/4"		
3/8"	3/8"	39.6mm	39.6mm									31.5mm	15/16"		

HC-Series Garden Hose Couplings

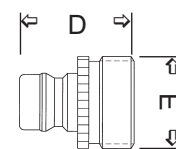
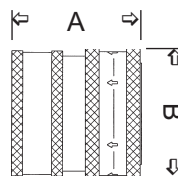

Body Size	End Size	Female GH	Female BSPP	Female ORB	Male GH	Male BSPT	Male ORB	Male JIC 37°	Hose Barb	Push-Loc Barb	Reusable Barb	Max. O.D.	Hex Size		
Coupler												Dimension 'A'		'B'	-
3/4"	3/4"	30.2mm										31.8mm			
Nipple												Dimension 'D'		'E'	-
3/4"	5/8"				-				35.8mm			26.7mm			
3/4"	3/4"				33.0mm				35.9mm			26.7mm			

K-Series ISO7241 Series 'A' Interchange

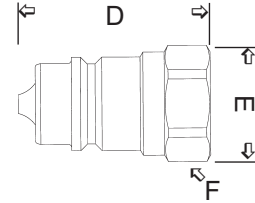
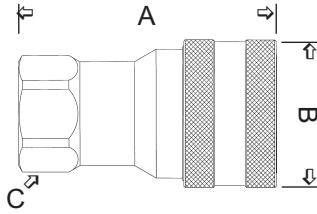

Body Size	End Size	Female NPT(F)	Female BSPP	Female ORB	Male NPT(F)	Male BSPT	Male ORB	Male JIC 37°	Hose Barb	Push-Loc Barb	Reusable Barb	Max. O.D.	Hex Size
Coupler		Dimension 'A'										'B'	'C'
1/4"	1/4"	51.0mm	51.0mm	-								26.0mm	19.0mm
3/8"	3/8"	58.5mm	58.5mm	58.5mm								32.0mm	24.0mm
1/2"	1/2"	63.5mm	63.5mm	63.5mm								38.0mm	30.0mm
1/2"	5/8"	-	-	-	65.9mm							38.0mm	30.0mm
1/2"	3/4"	65.0mm	65.0mm	-								38.0mm	38.0mm
3/4"	3/4"	83.5mm	83.5mm	83.5mm								46.0mm	38.0mm
1"	1"	97.0mm	97.0mm	97.0mm								55.0mm	46.0mm
1-1/4"	1-1/4"	117.0mm	117.0mm	-								70.0mm	60.0mm
1-1/2"	1-1/2"	133.0mm	133.0mm	-								84.5mm	70.0mm
2"	2"	165.0mm	165.0mm	-								100.0mm	75.0mm
Nipple		Dimension 'D'										'E'	'F'
1/4"	1/4"	36.0mm	36.0mm	-								28.4mm	19.0mm
3/8"	3/8"	40.5mm	40.5mm	40.5mm								36.1mm	22.0mm
1/2"	1/2"	46.0mm	46.0mm	46.0mm								47.2mm	27.0mm
1/2"	5/8"	-	-	48.8mm								47.2mm	27.0mm
1/2"	3/4"	49.6mm	49.6mm	-								47.2mm	30.0mm
3/4"	3/4"	56.0mm	56.0mm	56.0mm								90.2mm	36.0mm
1"	1"	63.0mm	63.0mm	63.0mm								104.9mm	41.0mm
1-1/4"	1-1/4"	75.0mm	75.0mm	-								57.7mm	50.0mm
1-1/2"	1-1/2"	83.5mm	83.5mm	-								69.3mm	60.0mm
2"	2"	105.0mm	105.0mm	-								86.6mm	75.0mm

EB-Series Water-Blast Interchange

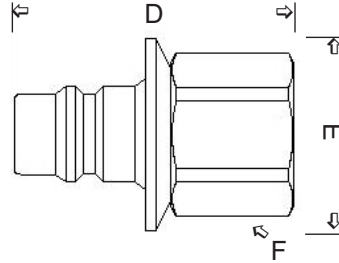
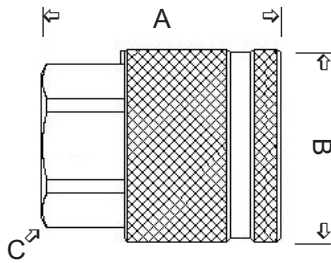

Body Size	End Size	Female NPT(F)	Female BSPP	Female ORB	Male NPT(F)	Male BSPT	Male ORB	Male JIC 37°	Hose Barb	Push-Loc Barb	Reusable Barb	Max. O.D.	Hex Size
Coupler		Dimension 'A'										'B'	'C'
1/2"	3/8"	55.9mm										41.1mm	1-1/4"
1/2"	1/2"	55.9mm										41.1mm	1-1/4"
Nipple		Dimension 'D'										'E'	'F'
1/2"	3/8"	59.7mm										41.1mm	1-1/8"
1/2"	1/2"	59.7mm										41.1mm	1-1/8"

AG-Series ISO5675 Agricultural Interchange

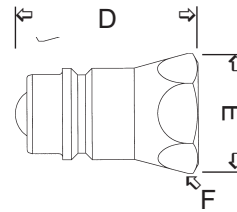
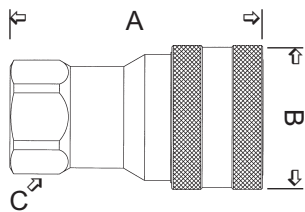

Body Size	End Size	Female NPT(F)	Female BSPP	Female ORB	Male NPT(F)	Male BSPT	Male ORB	Male JIC 37°	Hose Barb	Push-Loc Barb	Reusable Barb	Max. O.D.	Hex Size
Coupler												Dimension 'A'	
												'B'	'C'
1/4"	1/4"	53.5mm		-								27.0mm	22.0mm
3/8"	3/8"	61.0mm		-								34.0mm	27.0mm
1/2"	1/2"	63.5mm		63.5mm								38.0mm	30.0mm
1/2"	5/8"	-		63.5mm								38.0mm	30.0mm
1/2"	3/4"	68.9mm		-								38.0mm	38.0mm
3/4"	3/4"	85.0mm		-								48.0mm	38.0mm
1"	1"	96.5mm		-								55.0mm	46.0mm
Nipple												Dimension 'D'	
												'E'	'F'
1/4"	1/4"	36.0mm		-								28.4mm	19.0mm
3/8"	3/8"	40.5mm		-								36.1mm	24.0mm
1/2"	1/2"	46.0mm		46.0mm								47.2mm	27.0mm
1/2"	5/8"	-		46.0mm								47.2mm	27.0mm
1/2"	3/4"	49.6mm		-								47.2mm	30.0mm
3/4"	3/4"	56.0mm		-								90.2mm	36.0mm
1"	1"	63.0mm		-								104.9mm	41.0mm

W-Series Wingstyle Interchange

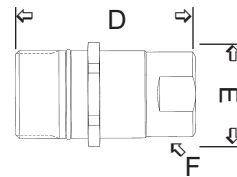
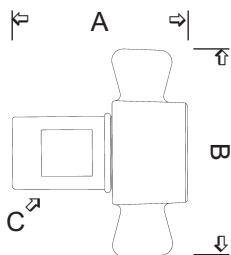

Body Size	End Size	Female NPT(F)	Female BSPP	Female ORB	Male NPT(F)	Male BSPT	Male ORB	Male JIC 37°	Hose Barb	Push-Loc Barb	Reusable Barb	Max. O.D.	Hex Size
Coupler												Dimension 'A'	
												'B'	'C'
3/4"	1/2"	78.5mm	78.5mm									103.1mm	1-5/32"
3/4"	3/4"	78.5mm	78.5mm									103.1mm	1-5/32"
1"	1"	96.0mm	96.0mm									113.0mm	1-7/16"
1-1/4"	1-1/4"	100.8mm	100.8mm									132.1mm	1-25/32"
1-1/2"	1-1/2"	112.3mm	112.3mm									135.1mm	2"
Nipple												Dimension 'D'	
												'E'	'F'
3/4"	1/2"	78.7mm	78.7mm									45.2mm	1-5/16"
3/4"	3/4"	78.7mm	78.7mm									45.2mm	1-5/16"
1"	1"	90.2mm	90.2mm									50.8mm	1-9/16"
1-1/4"	1-1/4"	94.2mm	94.2mm									60.5mm	1-7/8"
1-1/2"	1-1/2"	104.7mm	104.7mm									63.5mm	2-3/16"

HT-Series ISO16028 Flushface Interchange

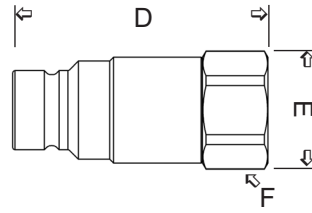
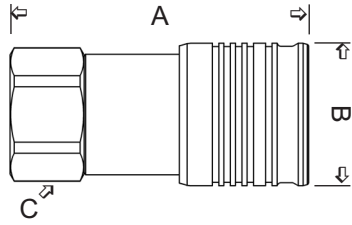

Body Size	End Size	Female NPT(F)	Female BSPP	Female ORB	Male NPT(F)	Male BSPT	Male ORB	Male JIC 37°	Hose Barb	Push-Loc Barb	Reusable Barb	Max. O.D.	Hex Size	
Coupler												Dimension 'A'	'B'	'C'
3/8"	3/8"	63.3mm	63.3mm	63.3mm	70.6mm	-	-	-	-	-	-	31.2mm	1-1/16"	
3/8"	1/2"	66.0mm	66.0mm	67.3mm	70.6mm	-	66.0mm	69.3	-	-	-	31.2mm	1-1/16"	
1/2"	1/2"	82.0mm	82.0mm	82.0mm	83.6mm	-	-	-	-	-	-	39.1mm	1-5/16"	
1/2"	5/8"	-	-	82.0mm	-	-	-	-	-	-	-	39.1mm	1-5/16"	
1/2"	3/4"	86.1mm	86.1mm	86.1mm	86.9mm	-	-	-	-	-	-	39.1mm	1-7/16"	
5/8"	5/8"	-	-	89.9mm	-	-	-	-	-	-	-	42.2mm	1-1/2"	
5/8"	3/4"	89.9mm	89.9mm	89.9mm	92.0mm	-	-	-	-	-	-	42.2mm	1/12"	
3/4"	3/4"	90.9mm	90.9mm	90.9mm	95.0mm	-	-	-	-	-	-	47.0mm	1-1/2"	
3/4"	1"	90.9mm	90.9mm	92.2mm	95.0mm	-	-	-	-	-	-	47.0mm	1-1/2"	
1"	1"	111.8mm	111.8mm	111.8mm	113.5mm	-	-	-	-	-	-	58.2mm	1-5/8"	
1"	1-1/4"	111.8mm	111.8mm	111.8mm	113.5mm	-	-	-	-	-	-	58.2mm	1-5/8"	

Body Size	End Size	Female NPT(F)	Female BSPP	Female ORB	Male NPT(F)	Male BSPT	Male ORB	Male JIC 37°	Hose Barb	Push-Loc Barb	Reusable Barb	Max. O.D.	Hex Size	
Nipple												Dimension 'D'	'E'	'F'
3/8"	3/8"	62.2mm	62.2mm	62.2mm	69.6mm	-	-	-	-	-	-	31.2mm	1-1/16"	
3/8"	1/2"	65.0mm	65.0mm	66.3mm	69.6mm	-	65.0mm	68.0mm	-	-	-	31.2mm	1-1/16"	
1/2"	1/2"	79.0mm	79.0mm	79.0mm	80.5mm	-	-	-	-	-	-	38.6mm	1-5/16"	
1/2"	5/8"	-	-	79.0mm	-	-	-	-	-	-	-	38.6mm	1-5/16"	
1/2"	3/4"	82.8mm	82.8mm	82.8mm	83.6mm	-	-	-	-	-	-	38.6mm	1-7/16"	
5/8"	5/8"	-	-	89.9mm	-	-	-	-	-	-	-	42.2mm	1-1/2"	
5/8"	3/4"	86.1mm	86.1mm	86.1mm	88.1mm	-	-	-	-	-	-	42.2mm	1/12"	
3/4"	3/4"	87.6mm	87.6mm	87.6mm	91.7mm	-	-	-	-	-	-	47.0mm	1-1/2"	
3/4"	1"	87.6mm	87.6mm	88.9mm	91.7mm	-	-	-	-	-	-	47.0mm	1-1/2"	
1"	1"	101.6mm	101.6mm	101.6mm	103.4mm	-	-	-	-	-	-	58.2mm	1-5/8"	
1"	1-1/4"	101.6mm	101.6mm	101.6mm	104.7mm	-	-	-	-	-	-	60.0mm	1-5/8"	

HG-Series General Purpose Flushface

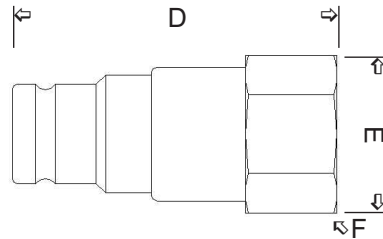
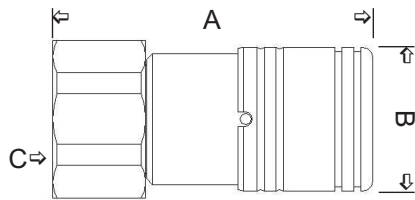

Body Size	End Size	Female NPT(F)	Female BSPP	Female ORB	Male NPT(F)	Male BSPT	Male ORB	Male JIC 37°	Hose Barb	Push-Loc Barb	Reusable Barb	Max. O.D.	Hex Size	
Coupler												Dimension 'A'	'B'	'C'
1/4"	1/4"	66.1mm	66.1mm	-	-	-	-	-	-	-	-	30.0mm	27.0mm	
3/8"	3/8"	66.1mm	66.1mm	-	-	-	-	-	-	-	-	30.0mm	27.0mm	
3/8"	1/2"	68.4mm	68.4mm	-	-	-	-	-	-	-	-	30.0mm	30.0mm	
1/2"	1/2"	27.0mm	27.0mm	-	-	-	-	-	-	-	-	38.0mm	27.0mm	
3/4"	3/4"	36.0mm	36.0mm	-	-	-	-	-	-	-	-	42.0mm	36.0mm	
1-1/2"	1-1/2"	132.6mm	132.6mm	-	-	-	-	-	-	-	-	80.0mm	65.0mm	
2"	2"	165.1mm	165.1mm	-	-	-	-	-	-	-	-	100.1mm	80.0mm	

Body Size	End Size	Female NPT(F)	Female BSPP	Female ORB	Male NPT(F)	Male BSPT	Male ORB	Male JIC 37°	Hose Barb	Push-Loc Barb	Reusable Barb	Max. O.D.	Hex Size	
Nipple												Dimension 'D'	'E'	'F'
1/4"	1/4"	66.1mm	66.1mm	-	-	-	-	-	-	-	-	23.8mm	27.0mm	
3/8"	3/8"	66.1mm	66.1mm	-	-	-	-	-	-	-	-	23.8mm	27.0mm	
3/8"	1/2"	68.4mm	68.4mm	-	-	-	-	-	-	-	-	24.6mm	30.0mm	
1/2"	1/2"	62.8mm	62.8mm	-	-	-	-	-	-	-	-	23.5mm	27.0mm	
3/4"	3/4"	72.0mm	72.0mm	-	-	-	-	-	-	-	-	30.0mm	36.0mm	
1-1/2"	1-1/2"	111.0mm	111.0mm	-	-	-	-	-	-	-	-	70.1mm	65.0mm	
2"	2"	125.0mm	125.0mm	-	-	-	-	-	-	-	-	83.6mm	80.0mm	

ST-Series Snap-Tite '71' Interchange

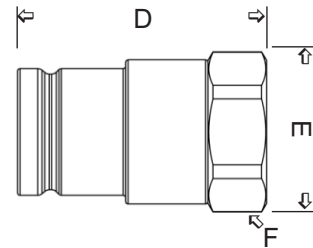
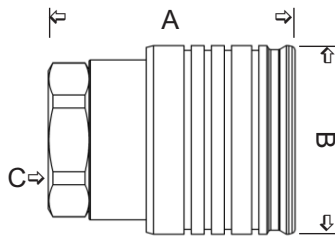

Body Size	End Size	Female NPT(F)	Female BSPP	Female ORB	Male NPT(F)	Male BSPT	Male ORB	Male JIC 37°	Hose Barb	Push-Loc Barb	Reusable Barb	Max. O.D.	Hex Size	
Coupler												Dimension 'A'	'B'	'C'
3/4"	3/4"	77.0mm	77.0mm	77.0mm								59.7mm	1-3/4"	
1"	1"	84.6mm	84.6mm	84.6mm								69.3mm	2"	
1"	1-1/4"	93.2mm	93.2mm	93.2mm								69.3mm	2"	
2"	1-1/2"	157.7mm	157.7mm	157.7mm								113.8mm	3-3/8"	
2"	2"	157.7mm	157.7mm	157.7mm								113.8mm	3-3/8"	
Nipple												Dimension 'D'	'E'	'F'
3/4"	3/4"	75.2mm	75.2mm	75.2mm								48.8mm	1-3/4"	
1"	1"	81.8mm	81.8mm	81.8mm								53.3mm	1-7/8"	
1"	1-1/4"	88.4mm	88.4mm	88.4mm								55.9mm	2"	
2"	1-1/2"	114.3mm	114.3mm	114.3mm								88.4mm	3-1/4"	
2"	2"	114.3mm	114.3mm	114.3mm								88.4mm	3-1/4"	

E-Series Straight-Through Interchange

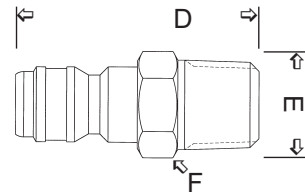
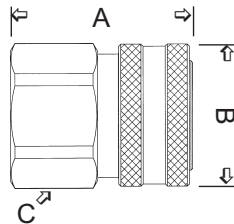

Body Size	End Size	Female NPT(F)	Female BSPP	Female ORB	Male NPT(F)	Male BSPT	Male ORB	Male JIC 37°	Hose Barb	Push-Loc Barb	Reusable Barb	Max. O.D.	Hex Size	
Coupler												Dimension 'A'	'B'	'C'
1/8"	1/8"	25.4mm			25.4mm				-			16.5mm	9/16"	
1/4"	1/4"	35.6mm			42.2mm				47.5mm			24.4mm	13/16"	
3/8"	3/8"	40.6mm			43.2mm				47.5mm			28.7mm	1"	
1/2"	1/2"	49.8mm			50.8mm				73.7mm			32.3mm	1-1/8"	
3/4"	3/4"	53.3mm			56.9mm				80.3mm			41.9mm	1-1/2"	
1"	1"	59.9mm			66.3mm				82.6mm			57.3mm	1-3/4"	
1-1/4"	1-1/4"	59.9mm			73.9mm				-			65.8mm	2-1/4"	
1-1/2"	1-1/2"	73.4mm			87.4mm				-			80.8mm	2-3/4"	
2"	2"	76.2mm			94.0mm				-			102.6mm	3-1/2"	
Nipple												Dimension 'D'	'E'	'F'
1/8"	1/8"	24.9mm			29.2mm				-			16.5mm	9/16"	
1/4"	1/4"	37.3mm			38.1mm				32.5mm			20.1mm	11/16"	
3/8"	3/8"	40.6mm			43.0mm				48.3mm			25.7mm	7/8"	
1/2"	1/2"	46.2mm			48.5mm				51.6mm			29.5mm	1"	
3/4"	3/4"	52.1mm			57.2mm				53.1mm			34.8mm	1-3/16"	
1"	1"	60.0mm			62.2mm				57.9mm			43.9mm	1-1/2"	
1-1/4"	1-1/4"	62.7mm			71.1mm				83.3mm			58.7mm	2"	
1-1/2"	1-1/2"	69.6mm			85.9mm				-			66.0mm	2-1/4"	
2"	2"	76.2mm			90.9mm				-			76.9mm	2-5/8"	

V-Series Snap-Tite 'H/IH' Interchange

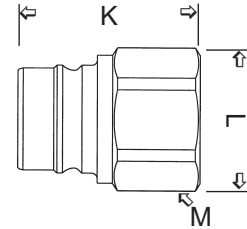
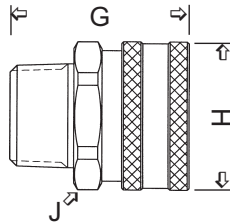
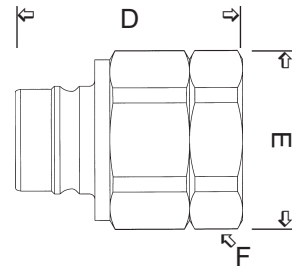
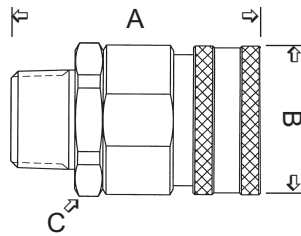

Body Size	End Size	Female NPT(F)	Female BSPP	Female ORB	Male NPT(F)	Male BSPT	Male ORB	Male JIC 37°	Hose Barb	Push-Loc Barb	Reusable Barb	Max. O.D.	Hex Size
Coupler		Dimension 'A'										'B'	'C'
1/4"	1/8"	42.7mm	-	-	53.9mm	-	-	-	-	-	-	25.2mm	7/8"
1/4"	1/4"	42.7mm	46.0mm	42.7mm	53.9mm	-	-	53.9mm	-	-	-	25.2mm	7/8"
3/8"	3/8"	49.3mm	51.1mm	49.3mm	58.9mm	-	-	58.9mm	-	-	-	30.0mm	1"
3/8"	1/2"	49.3mm	-	-	-	-	-	-	-	-	-	30.0mm	1"
1/2"	1/2"	54.1mm	54.1mm	54.1mm	64.8mm	-	-	64.8mm	-	-	-	34.5mm	1-3/16"
1/2"	3/4"	54.1mm	-	-	-	-	-	-	-	-	-	34.5mm	1-3/16"
3/4"	3/4"	62.7mm	75.2mm	62.7mm	78.0mm	-	-	78.0mm	-	-	-	42.4mm	1-1/2"
1"	1"	68.6mm	73.9mm	75.4mm	84.3mm	-	-	84.3mm	-	-	-	52.3mm	1-7/8"
1-1/4"	1-1/4"	89.9mm	89.9mm	89.9mm	91.2mm	-	-	-	-	-	-	55.6mm	2"
1-1/2"	1-1/2"	83.1mm	83.1mm	83.1mm	101.9mm	-	-	-	-	-	-	69.6mm	2-1/2"
2"	2"	99.6mm	99.6mm	99.6mm	115.3mm	-	-	-	-	-	-	97.3mm	3-1/2"
Nipple		Dimension 'D'										'E'	'F'
1/4"	1/8"	41.2mm	-	-	52.3mm	-	-	-	-	-	-	24.6mm	7/8"
1/4"	1/4"	41.2mm	49.5mm	49.5mm	52.3mm	-	-	52.3mm	-	-	-	24.6mm	7/8"
3/8"	3/8"	47.5mm	49.3mm	49.3mm	57.5mm	-	-	57.5mm	-	-	-	28.0mm	7/8"
3/8"	1/2"	47.5mm	-	-	-	-	-	-	-	-	-	28.0mm	7/8"
1/2"	1/2"	50.6mm	50.6mm	50.6mm	61.0mm	-	-	61.0mm	-	-	-	33.3mm	1-3/16"
1/2"	3/4"	50.6mm	-	-	-	-	-	-	-	-	-	33.3mm	1-3/16"
3/4"	3/4"	58.7mm	71.1mm	71.1mm	73.9mm	-	-	73.9mm	-	-	-	41.9mm	1-1/2"
1"	1"	66.0mm	72.9mm	72.9mm	81.8mm	-	-	81.8mm	-	-	-	52.3mm	1-7/8"
1-1/4"	1-1/4"	86.6mm	86.6mm	89.9mm	87.9mm	-	-	-	-	-	-	55.6mm	2"
1-1/2"	1-1/2"	78.7mm	79.0mm	83.1mm	97.8mm	-	-	-	-	-	-	69.6mm	2-1/2"
2"	2"	94.5mm	94.5mm	-	110.2mm	-	-	-	-	-	-	97.3mm	3-1/2"
Coupler		Dimension 'G'										'H'	'J'
1/4"	1/4"	34.5mm	34.5mm	-	34.5mm	-	-	-	-	-	-	25.2mm	7/8"
3/8"	3/8"	38.1mm	38.1mm	-	38.1mm	-	-	-	-	-	-	30.0mm	7/8"
1/2"	1/2"	41.7mm	41.7mm	-	41.7mm	-	-	-	-	-	-	34.5mm	1-3/16"
3/4"	3/4"	49.8mm	49.8mm	-	49.8mm	-	-	-	-	-	-	42.4mm	1-1/2"
1"	1"	53.3mm	53.3mm	-	53.3mm	-	-	-	-	-	-	52.3mm	1-13/16"
1-1/4"	1-1/4"	57.9mm	57.9mm	-	57.9mm	-	-	-	-	-	-	55.6mm	2"
1-1/2"	1-1/2"	65.3mm	65.3mm	-	65.3mm	-	-	-	-	-	-	69.6mm	2-1/2"
2"	2"	63.0mm	63.0mm	-	63.0mm	-	-	-	-	-	-	97.3mm	3-1/4"
Nipple		Dimension 'K'										'L'	'M'
1/4"	1/4"	32.3mm	32.3mm	-	32.3mm	-	-	-	-	-	-	17.5mm	5/8"
3/8"	3/8"	35.8mm	35.8mm	-	35.8mm	-	-	-	-	-	-	22.9mm	13/16"
1/2"	1/2"	43.7mm	43.7mm	-	43.7mm	-	-	-	-	-	-	27.9mm	1"
3/4"	3/4"	47.2mm	47.2mm	-	47.2mm	-	-	-	-	-	-	33.3mm	1-3/16"
1"	1"	52.8mm	52.8mm	-	52.8mm	-	-	-	-	-	-	41.9mm	1-1/2"
1-1/4"	1-1/4"	56.4mm	56.4mm	-	56.4mm	-	-	-	-	-	-	52.32mm	1-7/8"
1-1/2"	1-1/2"	62.0mm	62.0mm	-	62.0mm	-	-	-	-	-	-	59.2mm	2-1/8"
2"	2"	66.0mm	66.0mm	-	66.0mm	-	-	-	-	-	-	76.5mm	2-3/4"

CM-Series Mold Coolant Interchange

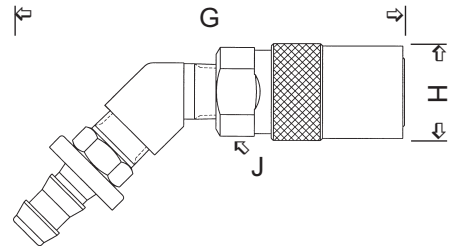
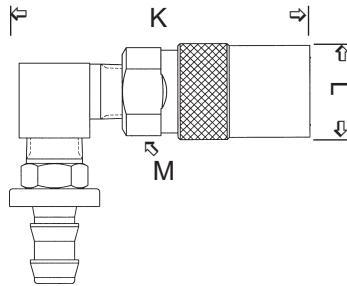
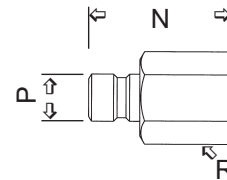
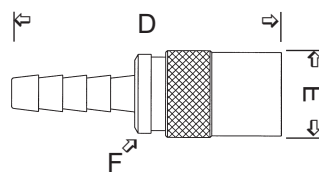
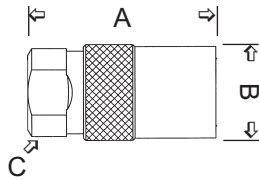

Body Size	End Size	Female NPT(F)	Female BSPP	Female ORB	Male NPT(F)	Male BSPT	Male ORB	Male JIC 37°	Hose Barb	Push-Loc Barb	Reusable Barb	Max. O.D.	Hex Size
Coupler (1)		Dimension 'A'										'B'	'C'
1/4"	1/8"	20.0mm										18.0mm	14.0mm
3/8"	1/4"	41.0mm										24.0mm	22.0mm
1/2"	1/2"	57.0mm										30.0mm	28.0mm
Coupler (2)		Dimension 'D'										'E'	'F'
1/4"	1/4"								53.0mm	50.5mm		18.0mm	14.0mm
1/4"	5/16"								55.5mm	-		18.0mm	14.0mm
1/4"	3/8"								58.0mm	55.5mm		18.0mm	14.0mm
3/8"	3/8"								75.0mm	71.5mm		24.0mm	22.0mm
3/8"	1/2"								80.0mm	76.5mm		24.0mm	22.0mm
1/2"	1/2"								85.0mm	82.8mm		30.0mm	28.0mm
1/2"	3/4"								90.0mm	87.8mm		30.0mm	28.0mm
Coupler (3)		Dimension 'G'										'H'	'J'
1/4"	1/4"								33.0mm	30.5mm		18.0mm	14.0mm
1/4"	5/16"								38.0mm	-		18.0mm	14.0mm
1/4"	3/8"								43.0mm	40.5mm		18.0mm	14.0mm
3/8"	3/8"								56.0mm	52.5mm		24.0mm	22.0mm
3/8"	1/2"								58.0mm	55.5mm		24.0mm	22.0mm
1/2"	1/2"								86.0mm	83.8mm		30.0mm	28.0mm
1/2"	3/4"								94.0mm	91.8mm		30.0mm	28.0mm
Coupler (4)		Dimension 'K'										'L'	'M'
1/4"	1/4"								42.0mm	40.0mm		18.0mm	14.0mm
1/4"	5/16"								42.0mm	-		18.0mm	14.0mm
1/4"	3/8"								44.0mm	42.0mm		18.0mm	14.0mm
3/8"	3/8"								56.0mm	53.8mm		24.0mm	22.0mm
3/8"	1/2"								58.0mm	55.8mm		24.0mm	22.0mm
1/2"	1/2"								60.0mm	57.0mm		30.0mm	28.0mm
1/2"	3/4"								60.0mm	57.0mm		30.0mm	28.0mm
Nipple		Dimension 'N'										'P'	'R'
1/4"	1/8"	24.6mm			23.6mm							9.4mm	11.0mm
1/4"	1/4"	25.5mm			28.6mm							9.4mm	14.0mm
1/4"	3/8"	25.5mm			30.6mm							9.4mm	17.0mm
3/8"	1/4"	25.0mm			33.0mm							13.5mm	14.0mm
3/8"	3/8"	35.0mm			34.0mm							13.5mm	17.0mm
3/8"	1/2"	35.0mm			34.0mm							13.5mm	17.0mm
1/2"	1/2"	38.2mm			42.2mm							19.9mm	24.0mm
1/2"	3/4"	44.2mm			46.5mm							19.9mm	26.0mm