

moldMAX[®] Pins

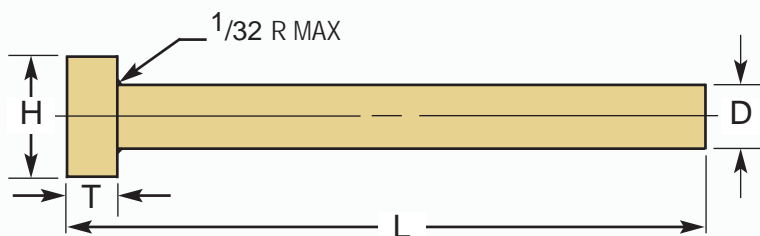

Tolerances	
Pin Diameter (D)	+0.000 -0.001
Head Diameter (H)	+0.000 -0.015
Head Thickness (T)	+0.000 -0.002
Length (L)	+0.062 -0.000

What's Important

- Hardness 36- 42 RC
- Resists corrosion, galling, and seizing
- Rapid and uniform heat removal reduces post cycle shrinkage and warpage
- Shorter cycle times with enhanced dimensional control
- High strength alloyed copper with superior thermal conductivity
- Special diameters available upon request

Material	Thermal Conductivity	Wear Resistance	Thermal Expansion	Hardness	Weldability	Machinability	Polishability	Corrosion Resistance	Total Score
<i>moldMAX</i>	4	7	9.0	7	10	7	10	10	55
P20 Tool Steel	1	5	6.5	6	4	3	5	5	29
Hardened Steel	1	10	6.5	10	2	1	2	5	31
420 Stainless	1	5	6.5	6	4	2	4	8	30

The mold materials shown in this chart were rated on their relative performance as experienced by mold makers on a scale from 1-10 with 10 indicating top performance. Thermal Expansion coefficient $10^{-6}/F$ is 9.7

Special Size?
Not a Problem!

CATALOG NUMBER	D PIN DIA	H HEAD DIA	T HEAD THICK.	L = LENGTH			
				4"	8"	12"	18"
CPM9-	.1250	1/4	1/8	•	•	•	
CPM11-	.1563	9/32	5/32	•	•	•	•
CPM13-	.1875	3/8	3/16	•	•	•	•
CPM15-	.2188	13/32	3/16	•	•	•	•
CPM17-	.2500	7/16	3/16	•	•	•	•
CPM19-	.2812	7/16	1/4	•	•	•	•
CPM21-	.3125	1/2	1/4	•	•	•	•
CPM25-	.3750	5/8	1/4	•	•	•	•
CPM29-	.4375	11/16	1/4	•	•	•	•
CPM33-	.5000	3/4	1/4	•	•	•	•
CPM35-	.5625	13/16	1/4	•	•	•	•
CPM37-	.6250	7/8	1/4	•	•	•	•
CPM41-	.7500	1	1/4	•	•	•	•

Add length to catalog number (i.e. CPM9-4)

moldMAX is a registered trademark of Brush Wellman Corp.

Home of the Hardened Throughout™ Pin

