

5 7/8" x 8" J Mold Bases - 68J

Ejector stroke data

C = (height of riser) = 1 5/8

S = (max stroke of ejector bar) = 7/8

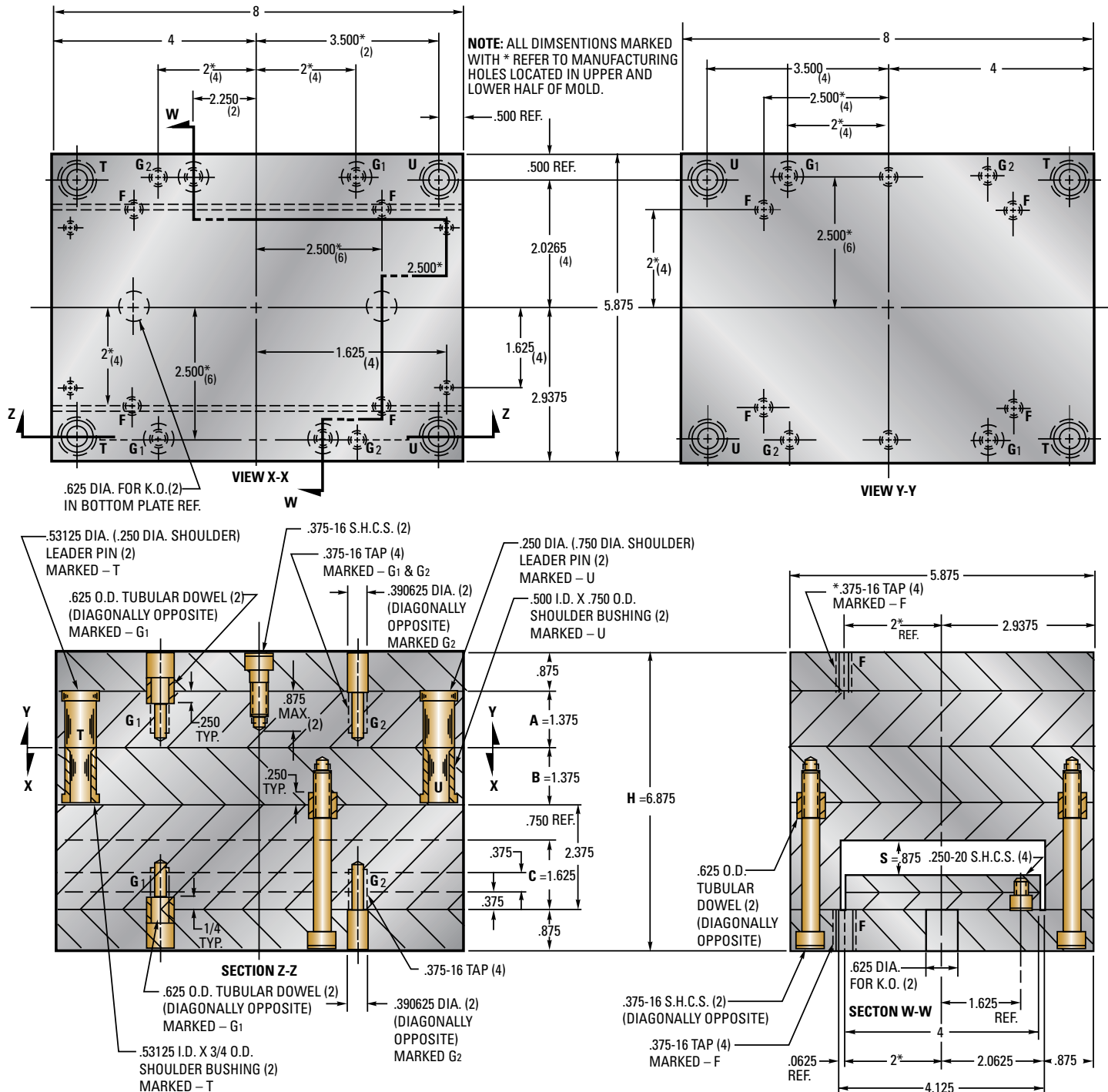

ITEM NUMBER	A	B	C	NET WT.
68J-13-13	1 3/8	1 3/8	1 5/8	84

WHEN ORDERING, PLEASE SPECIFY:

1. Quantity
2. Item Number
3. Method of Shipment

Small and Shuttle Mold Bases | 5 7/8" x 8" J Mold Bases