

# Standard Mold Base Terminology

## "A" AND REVERSE "A" SERIES ASSEMBLIES

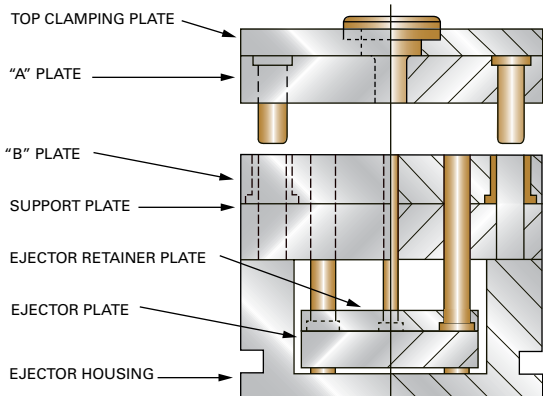

The most frequently used Standard Assembly, the "A" Series Mold Base is available in 43 sizes from  $7\frac{7}{8} \times 7\frac{7}{8}$  to  $23\frac{3}{4} \times 35\frac{1}{2}$ . See pages 50-135 for complete information.

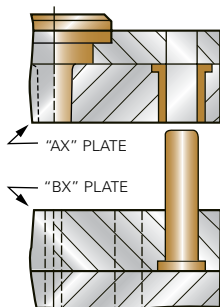

### REVERSE "A" SERIES

Identical to the "A" Series, with leader pins and bushings "reversed." Specify "AX" and "BX" plate thicknesses when ordering (rather than "A" and "B").

## "B" SERIES ASSEMBLY

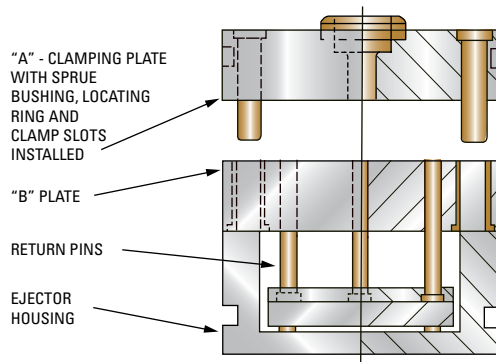

When cavities and cores are to be inserted into blind pockets, or machined directly into the "A" and "B" plates, the "B" Series Assembly is used. The Top Clamping Plate and Support Plate are omitted from the assembly.

## "X" SERIES (STRIPPER PLATE) ASSEMBLY

Most frequently used for molds requiring stripper plate ejection, the "X" Series Assembly is available with a Support Plate (6-plate series) or without a Support Plate (5-plate series).

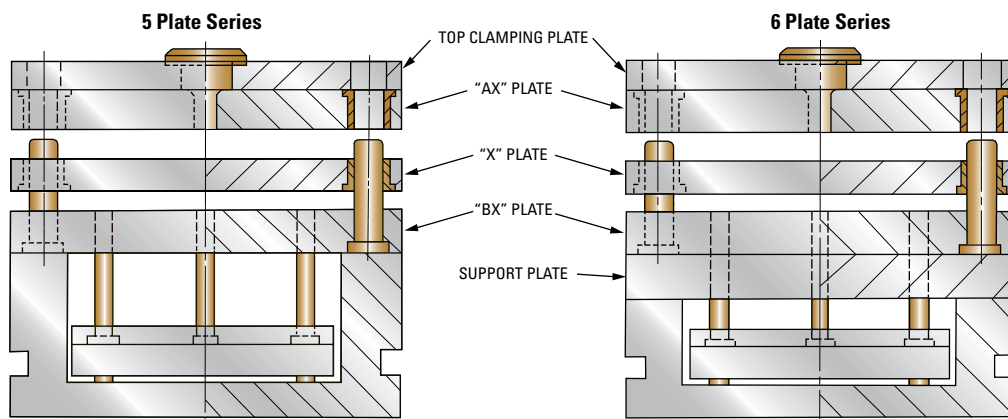

## "AX" SERIES ASSEMBLY

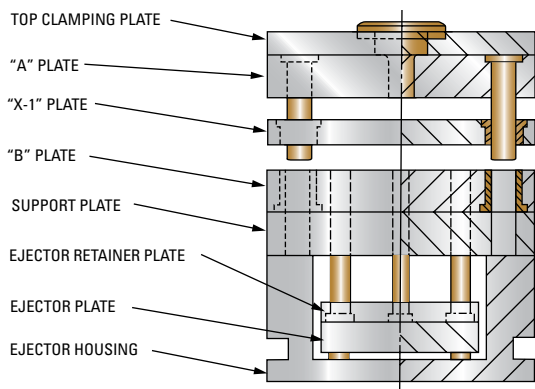

The "AX" Series Assembly is used when the mold requires a floating plate to remain with the upper or stationary half of the assembly. It is basically an "A" Series Assembly with a floating plate ("X-1") added.

## "T" SERIES ASSEMBLY

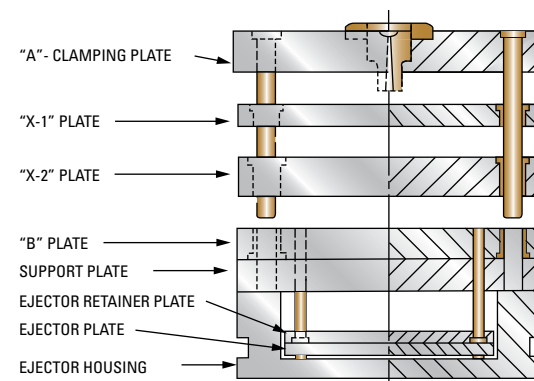

The "T" Series Assembly is used for top runner molds that require two floating plates ("X-1" — runner stripper plate, "X-2" — cavity plate) to remain with the upper or stationary half of the assembly.