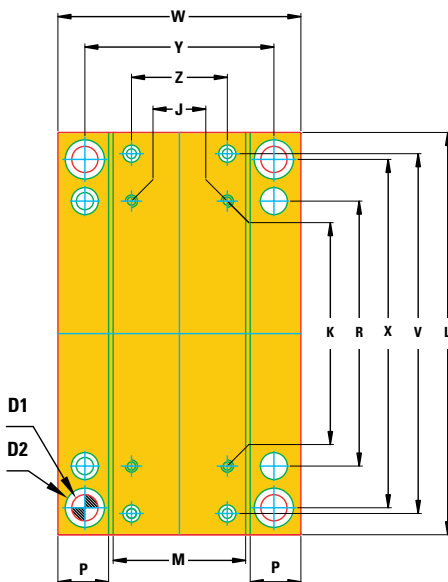
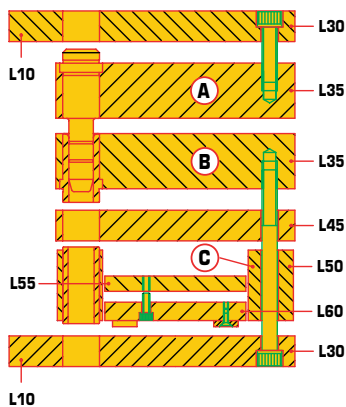

Plate Dimensions

Size code **2020 1925 2030 2525 2530 2535 2540 3030 3035 3040**
 Nominal size **196 x 196 190 x 246 196 x 296 246 x 246 246 x 296 246 x 346 246 x 396 296 x 296 296 x 346 296 x 396**

		2020	1925	2030	2525	2530	2535	2540	3030	3035	3040
W	Width	196	190	196	246	246	246	246	296	296	296
	L10 width (with overhang)	246	254	246	296	296	296	296	346	346	346
L	Length	196	246	296	246	296	346	396	296	346	396
X	Length of bore centers	152	202	244	200	244	294	340	244	294	340
Y	Width of bore centers	154	148	150	200	200	194	198	250	244	248
K	Length of ER screw centers	132	182	230	180	230	286	330	230	286	330
R	Length of assy screw centers	100	150	186	130	186	224	284	186	224	284
J	Width of ER screw centers	96	90	90	130	130	136	122	180	186	176
V	Length of RP centers	166	216	266	214	264	324	364	266	324	364
Z	Width of RP centers	96	90	90	130	130	136	122	180	186	176
P	L50 riser width	38	38	43	43	43	43	47	43	43	47
ER	L55 ER thick	12	12	12	12	12	17	17	12	17	17
EB	L60 EB thick	17	17	17	17	17	22	22	17	22	22
M	L55, L60, ER, EB width	118	112	108	158	158	158	150	208	208	200
D1	Bush ID	26	26	30	30	30	30	30	30	30	30
D2	Bore ID	31	31	35	35	35	35	35	35	35	35
D3	Assy screws	M10	M10	M12	M12	M12	M12	M12	M12	M12	M12
D4	ER screws	M8	M8	M8	M8	M8	M8	M8	M8	M8	M8



Euro-Series Plate Tolerances

	mm	L10, L55, L60	L50	L30, L45	L35
W, L	up to 100	+/- 0.06	+/- 0.06	+/- 0.03	+/- 0.008
	> 100 - 180	+/- 0.08	+/- 0.08	+/- 0.04	+/- 0.010
	> 180 - 315	+/- 0.10	+/- 0.10	+/- 0.05	+/- 0.012
	> 315 - 500	+/- 0.12	+/- 0.12	+/- 0.05	+/- 0.014
	> 500 - 710	+/- 0.15	+/- 0.15	+/- 0.05	+/- 0.017
	> 710 - 1000	+/- 0.20	+/- 0.20	+/- 0.05	+/- 0.020
T		+0.2 / +0.3	0 / +0.02	+0.2 / +0.3	+0.2 / +0.3
X, Y	up to 100	+/- 0.008	+/- 0.008	+/- 0.008	+/- 0.008
	> 100 - 180	+/- 0.010	+/- 0.010	+/- 0.010	+/- 0.010
	> 180 - 315	+/- 0.012	+/- 0.012	+/- 0.012	+/- 0.012
	> 315 - 500	+/- 0.015	+/- 0.015	+/- 0.015	+/- 0.015
	> 500 - 710	+/- 0.018	+/- 0.018	+/- 0.018	+/- 0.018
	> 710 - 1000	+/- 0.020	+/- 0.020	+/- 0.020	+/- 0.020