

Stripper Plate Series Mold Base Features

D-M-E Standard Stripper ("X" Series) Mold Bases are available with either the 5- or 6-plate construction. The location of the return pins, leader pins, screws and dowels are identical to the Standard "A" Series Mold Bases. Specifications are listed for every D-M-E Standard size from 7.875 × 7.875 to 23.75 × 35.5.

5 PLATE SERIES

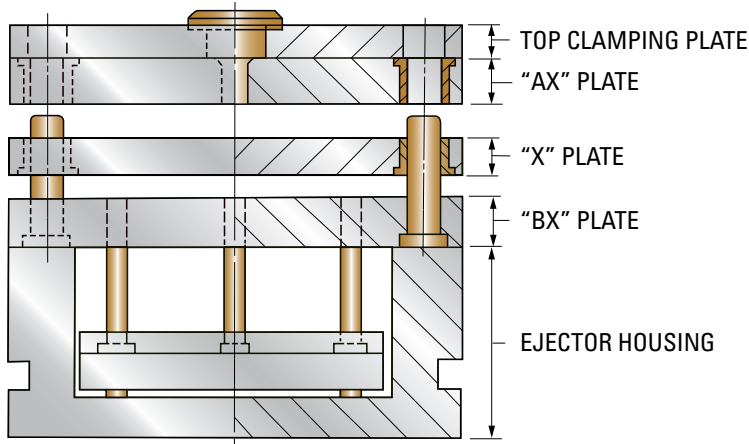

6 PLATE SERIES

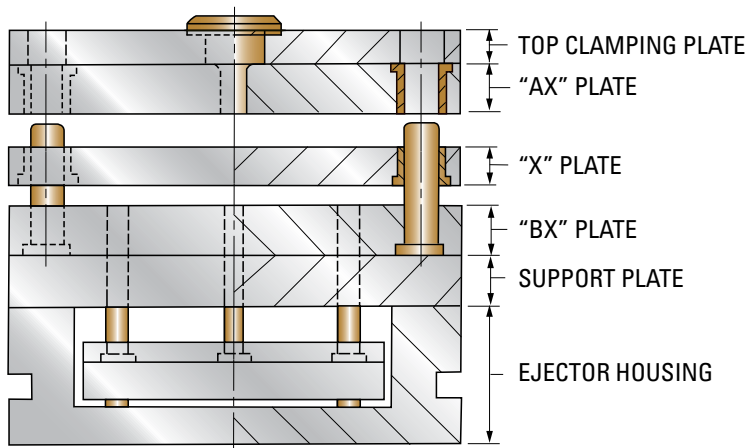

AX- and T-Series Mold Base Features

“AX” Series Mold Bases

A D-M-E Standard “AX” Series Mold Base is basically an “A” Series type mold base with a floating plate (“X-1” plate) added between the cavity plates. This type assembly is used when it is desirable to have the floating plate remain with the upper half of the assembly.

“AX” SERIES

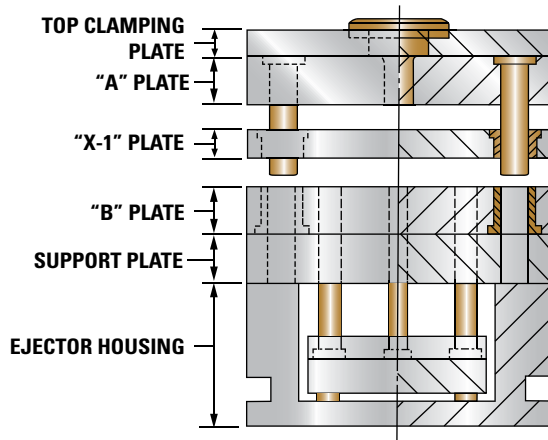

“T” Series Mold Bases

D-M-E Standard “T” Series Mold Bases are available in 42 standard sizes, from 7.875 × 7.875 to 23.75 × 35.5. They are used for top runner molds that require two floating plates (“X-1” – runner stripper plate, “X-2” – cavity plate) to remain with the upper or stationary half of the assembly.

“T” SERIES

