

# Locating Rings



Features supplied as standard unless otherwise specified.

The Locating Ring aligns the mold base to the stationary platen side of the press and positions the sprue bushing correctly.

## FOR QUOTING OR ORDERING, SPECIFY:

### Locating Rings

Standard 6501 D = 3.990

Other \_\_\_\_\_  
(refer to table below and D-M-E Mold Components catalog)

### Position/Omission:

Position on center  Center

or relocate to

X \_\_\_\_\_ Y \_\_\_\_\_

Omit locating ring machining

Omit locating ring

Rotate tapped holes

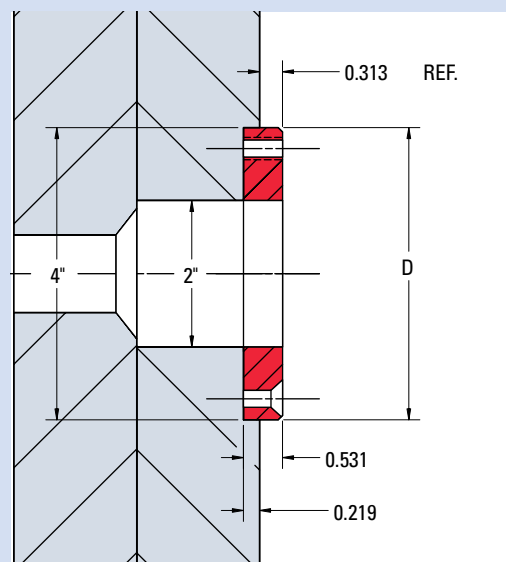
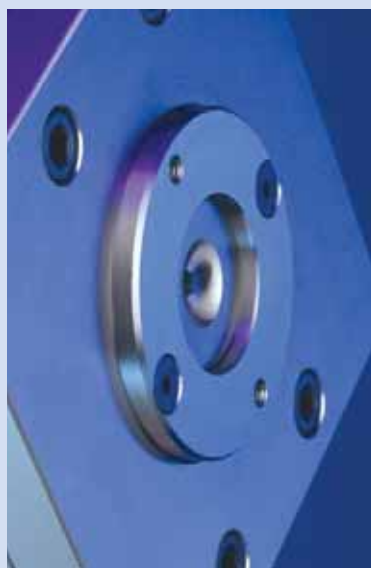

## Locating Ring Options

ITEM NUMBER	Ø D	DESCRIPTION
6500	2.615	
6501	3.990	STANDARD SERIES
6501LN	3.990	LN SERIES
6502	4.990	
6503	2.000	
6504	3.990	CLAMP TYPE
6505LN	5.990	LN SERIES
6510	7.995	
6511	2.990	
6520	3.990	EXTENSION NOZZLE TYPE
6521	3.990	STANDARD SERIES
6522	3.990	EXTENSION NOZZLE TYPE
6524	3.990	CLAMP TYPE
6534**	1.574	TOP AND BOTTOM RING
6535	3.541	
6536	4.331	TOP RING
6537	4.331	BOTTOM RING
6541*	3.990	STANDARD SERIES
6544*	3.990	CLAMP TYPE

\* For use with high-temperature insulator sheets.

\*\* For use with 3.5 x 3.75 Arburg Mold Bases.

See D-M-E Mold Components catalog for dimensions of other locating rings.

Locating ring #6501 shown; refer to D-M-E Mold Components catalog for dimensions of other locating rings.