

# Keyed Ejector Pins

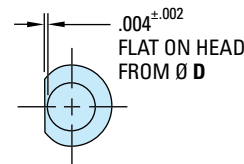
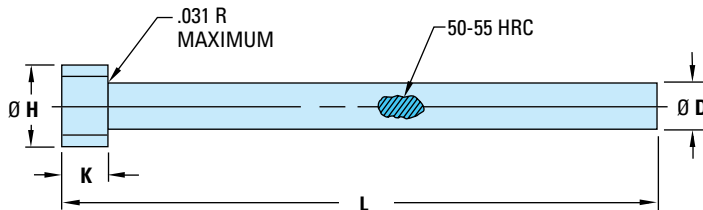

## Keyed Ejector Pins – THXK

Ø D PIN DIAMETER FRAC./DEC.	Ø D TOLERANCE	ITEM NUMBER	L LENGTH	Ø H HEAD DIA	Ø K HEAD THICKNESS
(1/8) .1250	-.0003 -.0006	THXK0906	6.00	.250	.125
		THXK0914	14.00		
(9/64) .1406	-.0003 -.0006	THXK1014	14.00	.250	.125
(5/32) .1562	-.0003 -.0006	THXK1114	14.00	.281	.156
(3/16) .1875	-.0003 -.0006	THXK1306	6.00	.375	.187
		THXK1314	14.00		
(7/32) .2187	-.0003 -.0006	THXK1514	14.00	.406	.187
(1/4) .2500	-.0003 -.0006	THXK1706	6.00	.437	.187
		THXK1714	14.00		
(5/16) .3125	-.0003 -.0006	THXK2106	6.00	.500	.250
		THXK2114	14.00		
(3/8) .3750	-.0003 -.0006	THXK2506	6.00	.625	.250
		THXK2514	14.00		
(7/16) .4375	-.0003 -.0006	THXK2525	25.00	.687	.250
		THXK2914	14.00		
(1/2) .5000	-.0003 -.0008	THXK3314	14.00	.750	.250
(5/8) .6250	-.0003 -.0008	THXK3714	14.00	.875	.250
(3/4) .7500	-.0003 -.0008	THXK4114	14.00	1.000	.250
		THXK4125	25.00		
(1") 1.000	-.0003 -.0008	THXK4714	14.00	1.250	.250
		THXK4725	25.00		

### INFORMATION KEY:

**D** = Pin Diameter  
**H** = Head Diameter  
**K** = Head Thickness  
**L** = Length  
**Material:** H-13 / 1.2344 / SKD61  
**Surface Treatment:** Nitrided  
**Surface Hardness:** 65 min. HRC  
**Core Hardness:** 50-55 HRC

- Precision-machined flat on head keeps pin from rotating
- Made from superior quality thermal shock-resisting hotwork steel
- Core hardness of 50-55 HRC makes these pins ideal for use in die-cast dies or other high temperature applications
- Annealed hot-forged heads provide uniform grain flow while allowing for easier machining