

DIN Ejector Blades – Nitrided

DIN Ejector Blades – EJB-EHN

Expulsores planos | Extractores laminares | Ejecteurs lames | Auswerferklingen

INFORMATION KEY:
D = Shoulder Diameter
H = Head Diameter
K = Head Thickness
L = Length
S = Shoulder Length
T = Blade Thickness
W = Blade Width
Standard: DIN/ISO Type
Material: 1.2344 (AISI H13 Type) Steel
Surface Treatment: Nitrided
Max. Temp.: 500°-550°C (932°-1022°F)
Dimensions: Shown in Millimeters (mm)

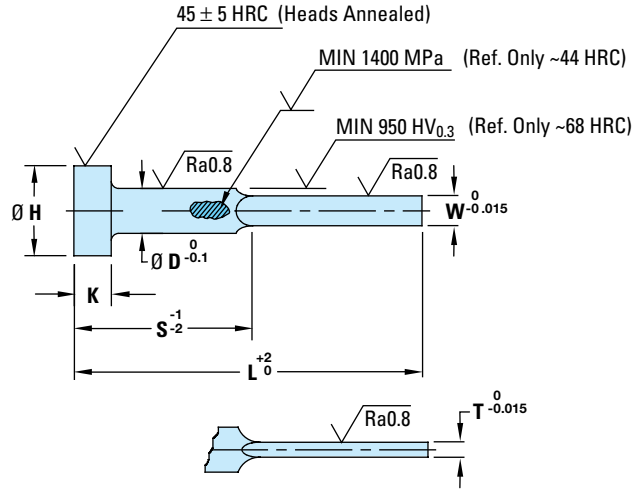

ITEM PREFIX	T	W	D	H	K	L									
						0060	0080	0100	0125	0160	0200	0250	0315	0400	
						S									
						30	40	50	63	80	100	125	160	200	
EJB-EHN (FW)*	01.0	03.5	4	8	3										
	01.0	03.8	4.2	8	3				⚡	⚡					
	01.0	04.5	5	10	3				⚡	⚡					
	01.0	05.5	6	12	5				⚡	⚡					
	01.2	03.5	4	8	3										
	01.2	03.8	4.2	8	3										
	01.2	04.5	5	10	3										
	01.2	05.5	6	12	5				⚡	⚡					
	01.2	07.5	8	14	5				⚡	⚡					
	01.5	04.5	5	10	5										
	01.5	05.5	6	12	5				⚡	⚡	⚡				
	01.5	07.5	8	14	5				⚡	⚡	⚡	⚡			
	01.5	09.5	10	16	3						⚡	⚡	⚡		
	01.8	09.5	10	16	5										
	02.0	05.5	6	12	5				⚡	⚡	⚡				
	02.0	07.5	8	14	5					⚡	⚡		⚡		
	02.0	09.5	10	16	5						⚡				
	02.0	11.5	12	18	7						⚡		⚡		
	02.0	12.0	12.5	18	7										
	02.0	15.5	16	22	7										
	02.5	11.5	12	20	7						⚡			⚡	
	02.5	12.0	12.5	18	7										
	02.5	15.5	16	22	7										

*“(FW)” is only a cross-reference to current D-M-E Europe Catalog item prefix numbers.

HOW TO ORDER: Specify Item Number with prefix, T thickness, W width, and L length. Include zeros and dashes but omit decimals, as shown.

Prefix T W L
EJB-EHN - [] - [] - []

Example:
 Prefix T W L
 EJB-EHN-010-038-0125

Example:
 Prefix T W L
 EJB-EHN-020-115-0200

KEY TO CHART
 Items in stock
 2-3 week delivery
 Contact D-M-E for quote

DIN Ejector Blades – Hardened

DIN Ejector Blades – EJB-ELH

Expulsores planos | Extractores laminares | Ejecteurs lames | Auswerferklingen

INFORMATION KEY:
D = Shoulder Diameter
H = Head Diameter
K = Head Thickness
L = Length
S = Shoulder Length
T = Blade Thickness
W = Blade Width
Standard: DIN/ISO Type
Material: 1.2210 (AISI L2 Type) Steel
Surface Treatment: None (Through-Hardened)
Max. Temp.: 250°C (482°F)
Dimensions: Shown in Millimeters (mm)

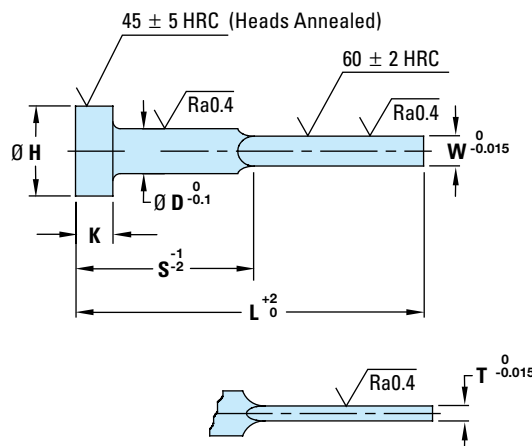

ITEM PREFIX	T	W	D	H	K	L											
						0060	0080	0100	0125	0160	0200	0250	0315	0400			
						S											
	30	40	50	63	80	100	125	160	200								
EJB-ELH (FK)*	01.0	03.5	4	8	3												
	01.0	03.8	4.2	8	3												
	01.0	04.5	5	10	3												
	01.0	05.5	6	12	5												
	01.2	03.8	4.2	8	3												
	01.2	04.5	5	10	3												
	01.2	05.5	6	12	5												
	01.2	07.5	8	14	5												
	01.5	04.5	5	10	3												
	01.5	05.5	6	12	5												
	01.5	07.5	8	14	5												
	01.5	09.5	10	16	5												
	02.0	05.5	6	12	5												
	02.0	07.5	8	14	5												
	02.0	09.5	10	16	5												
	02.0	11.5	12	18	7												
	02.0	15.5	16	22	7												
	02.5	11.5	12	18	7												
02.5	15.5	16	22	7													

* "(FK)" is only a cross-reference to current D-M-E Europe Catalog item prefix numbers.

HOW TO ORDER: Specify Item Number with prefix, T thickness, W width, and L length. Include zeros and dashes but omit decimals, as shown.

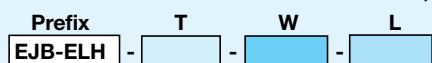

Example:
 Prefix T W L
 EJB-ELH-010-035-0060

Example:
 Prefix T W L
 EJB-ELH-020-115-0200

KEY TO CHART
 Items in stock
 2-3 week delivery
 Contact D-M-E for quote

DIN Pins, Sleeves, Blades | DIN Ejector Blades – Hardened