

Straight Brass Plug Baffles

D-M-E Brass Plug Baffles, available in both straight and spiral styles, are constructed entirely of high-quality brass with blades brazed to the plugs for long, dependable service. They provide a high-pressure seal through a deliberate difference of taper between the plug and the tapped hole.

Straight Baffles



The function of the baffle is to split the drilled waterline into two equal channels. As the heating or cooling medium enters, the baffle diverts the flow to travel up to and over the end of the baffle and down the other side.

Clearance must be provided between the end of the baffle and the end of the drilled channel to provide adequate flow. See Dimension "C" for approximate clearances.

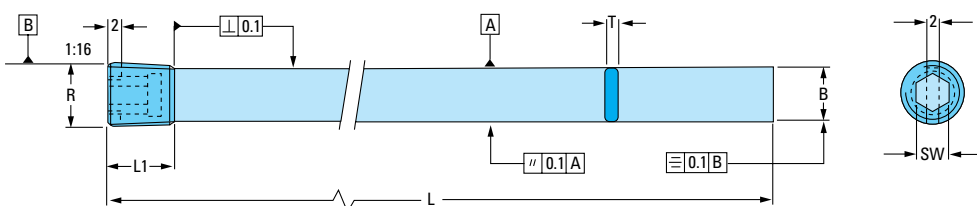

NOTE: A drilled hole (finish d^{H13}) is adequate. Don't ream the hole.

Thread Size

THREAD LENGTHS	
NOMINAL PLUG SIZE	THREAD LENGTH ^{+0.000} _{-.015}
1/16 & 1/8	.250
1/4 & 3/8	.406
1/2 & 3/4	.531
1"	.656

Hex Size

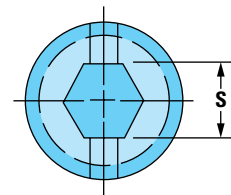

Slot indicates Baffle Position

Straight Brass Plug Baffles (Inch) – BB

ITEM NUMBER	NOMINAL PLUG SIZE	HEX SIZE S	NOMINAL LENGTH OVERALL	BAFFLE THICKNESS	BAFFLE WIDTH ^{-.005} _{-.015}	DRILL SIZE	C
BB-05-4	1/16	5/32	4"	.050	1/4	1/4	.10
BB-05-8	1/16	5/32	8"	.050	1/4	1/4	.10
BB-10-4	1/8	3/16	4"	1/16	5/16	5/16	.12
BB-10-8	1/8	3/16	8"	1/16	5/16	5/16	.12
BB-20-5	1/4	1/4	5"	3/32	7/16	7/16	.17
BB-20-10	1/4	1/4	10"	3/32	7/16	7/16	.17
BB-40-6	3/8	5/16	6"	3/32	9/16	9/16	.21
BB-40-12	3/8	5/16	12"	3/32	9/16	9/16	.21
BB-60-8	1/2	3/8	8"	3/32	11/16	11/16	.26
BB-60-16	1/2	3/8	16"	3/32	11/16	11/16	.26
BB-100-12	3/4	9/16	12"	1/8	15/16	15/16	.35
BB-100-20	3/4	9/16	20"	1/8	15/16	15/16	.35
BB-140-16	1	5/8	16"	1/8	1 1/8	1 1/8	.42
BB-140-24	1	5/8	24"	1/8	1 1/8	1 1/8	.42

Typical Applications

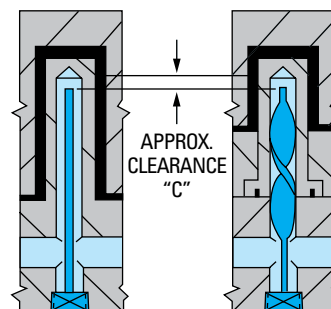
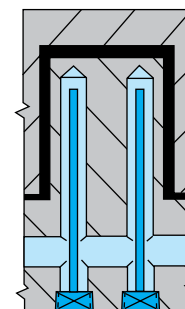

Straight Brass Plug Baffles (Metric) – BB

ITEM NUMBER	R	SW	B	L	L1	T	d
BB-100-18	1/8" BSP	5	8.2	100	8	2.0	8.5
BB-200-18	1/8" BSP	5	8.2	200	8	2.0	8.5
BB-125-14	1/4" BSP	6	11.2	125	10	2.5	11.5
BB-250-14	1/4" BSP	6	11.2	250	10	2.5	11.5
BB-150-38	3/8" BSP	8	14.7	150	10	2.5	15.0
BB-300-38	3/8" BSP	8	14.7	300	10	2.5	15.0
BB-200-12	1/2" BSP	10	18.2	200	10	2.5	18.5
BB-400-12	1/2" BSP	10	18.2	400	10	2.5	18.5
BB-300-34	3/4" BSP	12	23.2	300	12	3.0	23.5
BB-500-34	3/4" BSP	12	23.2	500	12	3.0	23.5

Spiral Brass Plug Baffles

Spiral Baffles

Spiral baffles improve cooling balance by creating turbulent action in the channel, reducing laminar or straight-layered flow patterns and providing efficient coolant movement.

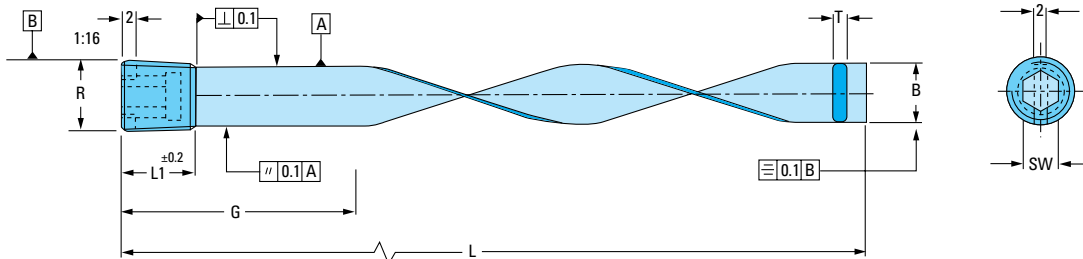
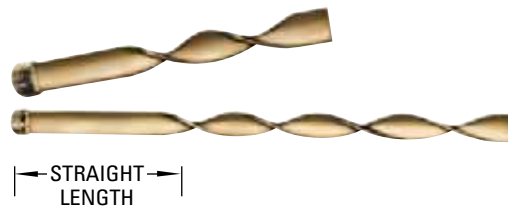

NOTE: A drilled hole (finish $d1^{H13}$) is adequate. Don't ream the hole.

Spiral Brass Plug Baffles (Inch) – BBS

ITEM NUMBER	NOMINAL PLUG SIZE	HEX SIZE S	NOMINAL LENGTH OVERALL	STRAIGHT LENGTH	BAFFLE THICKNESS	BAFFLE WIDTH -.005 -.015	DRILL SIZE	C
BBS-05-04	1/16	5/32	4"	2"	.050	1/4	1/4	.10
BBS-05-08	1/16	5/32	8"	4"	.050	1/4	1/4	.10
BBS-10-04	1/8	3/16	4"	2"	1/16	5/16	5/16	.12
BBS-10-08	1/8	3/16	8"	4"	1/16	5/16	5/16	.12
BBS-20-05	1/4	1/4	5"	2"	3/32	7/16	7/16	.17
BBS-20-10	1/4	1/4	10"	4"	3/32	7/16	7/16	.17
BBS-40-06	3/8	5/16	6"	2"	3/32	9/16	9/16	.21
BBS-40-12	3/8	5/16	12"	4"	3/32	9/16	9/16	.21
BBS-60-08	1/2	3/8	8"	3"	3/32	11/16	11/16	.26
BBS-60-16	1/2	3/8	16"	5"	3/32	11/16	11/16	.26
BBS-100-12	3/4	9/16	11 7/8	4"	1/8	15/16	15/16	.35
BBS-100-20	3/4	9/16	19 7/8	6"	1/8	15/16	15/16	.35
BBS-140-16	1	5/8	15 7/8	5"	1/8	1 1/8	1 1/8	.42
BBS-140-24	1	5/8	23 7/8	8"	1/8	1 1/8	1 1/8	.42

Spiral Brass Plug Baffles (Metric) – BBS

ITEM NUMBER	R	G	SW	B	L	L1	T	d1
BBS-100-116	1/16"	51	4	6.5	101	8	1.6	6.8
BBS-200-116	1/16"	102	4	6.5	203	8	1.6	6.8
BBS-100-18	1/8"	51	5	8.5	101	8	1.6	8.8
BBS-200-18	1/8"	102	5	8.5	203	8	1.6	8.8
BBS-125-14	1/4"	51	7	11.5	127	10	2.4	11.8
BBS-250-14	1/4"	102	7	11.5	254	10	2.4	11.8
BBS-150-38	3/8"	51	8	15.0	152	10	2.4	15.3
BBS-300-38	3/8"	102	8	15.0	305	10	2.4	15.3
BBS-200-12	1/2"	76	10	18.5	203	10	2.4	18.8
BBS-400-12	1/2"	127	10	18.5	406	10	2.4	18.8
BBS-300-34	3/4"	102	12	23.5	305	12	3.2	23.8
BBS-500-34	3/4"	153	12	23.5	508	12	3.2	23.8
BBS-400-1	1"	127	12	28.5	406	12	3.2	28.8
BBS-600-1	1"	203	12	28.5	610	12	3.2	28.8