

Guide Pins – Hardened and Precision Ground

Guide Pins – GL

Hardened and Precision Ground



General Dimensions

| NOMINAL DIA | Ø D ^{+0.000} / _{-0.005} | Ø H ^{+0.000} / _{-0.030} | K | Ø E ^{+0.005} / _{-0.000} |
|-------------|---|---|------|---|
| 3/4 | .749 | .990 | 3/16 | .751 |
| 7/8 | .874 | 1.115 | 1/4 | .876 |
| 1" | .999 | 1.240 | 1/4 | 1.001 |
| 1 1/4 | 1.249 | 1.490 | 5/16 | 1.251 |
| 1 1/2 | 1.499 | 1.740 | 5/16 | 1.501 |

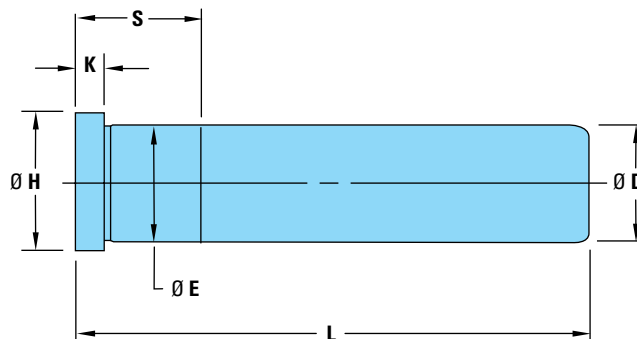

| L LENGTH ^{+0.00} / _{-0.06} | Ø D = 3/4 DIA .749 ^{+0.000} / _{-0.005} | | Ø D = 7/8 DIA .874 ^{+0.000} / _{-0.005} | | Ø D = 1" DIA .999 ^{+0.000} / _{-0.005} | | Ø D = 1 1/4 DIA 1.249 ^{+0.000} / _{-0.005} | | Ø D = 1 1/2 DIA 1.499 ^{+0.000} / _{-0.005} | | L LENGTH ^{+0.00} / _{-0.06} |
|--|---|-------------|---|-------------|--|-------------|--|-------------|--|-------------|--|
| | S | ITEM NUMBER | S | ITEM NUMBER | S | ITEM NUMBER | S | ITEM NUMBER | S | ITEM NUMBER | |
| 1 3/4 | 7/8 | 5000-GL | 7/8 | 5099-GL | 7/8 | 5198-GL | — | — | — | — | 1 3/4 |
| 2 1/4 | 7/8 | 5001-GL | 7/8 | 5100-GL | 7/8 | 5199-GL | — | — | — | — | 2 1/4 |
| 2 3/4 | 7/8 | 5002-GL | 7/8 | 5101-GL | 7/8 | 5200-GL | 7/8 | 5300-GL | — | — | 2 3/4 |
| 3 1/4 | 7/8 | 5003-GL | 7/8 | 5102-GL | 7/8 | 5201-GL | 7/8 | 5301-GL | — | — | 3 1/4 |
| 3 3/4 | 7/8 | 5004-GL | 7/8 | 5103-GL | 7/8 | 5202-GL | 7/8 | 5302-GL | 1 3/8 | 5402-GL | 3 3/4 |
| 4 1/4 | 1 3/8 | 5005-GL | 1 3/8 | 5104-GL | 1 3/8 | 5203-GL | 7/8 | 5303-GL | 1 3/8 | 5403-GL | 4 1/4 |
| 4 3/4 | 1 3/8 | 5006-GL | 1 3/8 | 5105-GL | 1 3/8 | 5204-GL | 1 3/8 | 5304-GL | 1 3/8 | 5404-GL | 4 3/4 |
| 5 1/4 | 1 3/8 | 5007-GL | 1 3/8 | 5106-GL | 1 3/8 | 5205-GL | 1 3/8 | 5305-GL | 1 3/8 | 5405-GL | 5 1/4 |
| 5 3/4 | 1 7/8 | 5008-GL | 1 3/8 | 5107-GL | 1 3/8 | 5206-GL | 1 3/8 | 5306-GL | 1 3/8 | 5406-GL | 5 3/4 |
| 6 1/4 | 1 7/8 | 5009-GL | 1 7/8 | 5108-GL | 1 3/8 | 5207-GL | 1 3/8 | 5307-GL | 1 3/8 | 5407-GL | 6 1/4 |
| 6 3/4 | 1 7/8 | 5010-GL | 1 7/8 | 5109-GL | 1 7/8 | 5208-GL | 1 7/8 | 5308-GL | 1 3/8 | 5408-GL | 6 3/4 |
| 7 1/4 | 1 7/8 | 5011-GL | 1 7/8 | 5110-GL | 1 7/8 | 5209-GL | 1 7/8 | 5309-GL | — | — | 7 1/4 |
| 7 3/4 | 1 7/8 | 5012-GL | 1 7/8 | 5111-GL | 1 7/8 | 5210-GL | 1 7/8 | 5310-GL | 1 7/8 | 5410-GL | 7 3/4 |
| 8 1/4 | — | — | 1 7/8 | 5112-GL | 1 7/8 | 5211-GL | 1 7/8 | 5311-GL | — | — | 8 1/4 |
| 8 3/4 | — | — | 1 7/8 | 5113-GL | 1 7/8 | 5212-GL | 1 7/8 | 5312-GL | 1 7/8 | 5412-GL | 8 3/4 |
| 9 1/4 | 1 7/8 | 5015-GL | — | — | 1 7/8 | 5213-GL | 1 7/8 | 5313-GL | — | — | 9 1/4 |
| 9 3/4 | — | — | — | — | 1 7/8 | 5214-GL | 1 7/8 | 5314-GL | 1 7/8 | 5414-GL | 9 3/4 |
| 10 1/4 | — | — | — | — | 1 7/8 | 5215-GL | 1 7/8 | 5315-GL | — | — | 10 1/4 |
| 10 3/4 | — | — | 1 7/8 | 5117-GL | 1 7/8 | 5216-GL | 1 7/8 | 5316-GL | 1 7/8 | 5416-GL | 10 3/4 |
| 11 1/4 | — | — | — | — | 1 7/8 | 5217-GL | 1 7/8 | 5317-GL | — | — | 11 1/4 |
| 11 3/4 | — | — | — | — | 1 7/8 | 5218-GL | 1 7/8 | 5318-GL | 1 7/8 | 5418-GL | 11 3/4 |
| 12 1/4 | — | — | 1 7/8 | 5120-GL | 1 7/8 | 5219-GL | 1 7/8 | 5319-GL | — | — | 12 1/4 |
| 12 3/4 | — | — | — | — | — | — | 1 7/8 | 5320-GL | 1 7/8 | 5420-GL | 12 3/4 |
| 13 3/4 | — | — | — | — | — | — | 1 7/8 | 5322-GL | 1 7/8 | 5422-GL | 13 3/4 |
| 14 3/4 | — | — | — | — | — | — | 1 7/8 | 5324-GL | 1 7/8 | 5424-GL | 14 3/4 |
| 15 3/4 | — | — | — | — | — | — | 1 7/8 | 5326-GL | 1 7/8 | 5426-GL | 15 3/4 |

NOTE: Grooved guide pins also available on special order.

All items in stock.

QUANTITY DISCOUNTS: Leader Pins and Bushings. Discounts apply to current Net Prices. Any combination of pins and bushings may be mixed for quantity discounts. 16 to 27 Less 10%; 28 or more Less 15%