

Recycling Inserts

U.S. Patent No. D324,392



Benefits of Recycling Inserts

- Saves outsourcing and engraving costs
- Easily installed
- Easily interchanged
- Complies with SPI standards

Installation

- Press fit installation required.
- Maintain a close tolerance press fit. Too loose a fit could allow the insert to move out of position.
- Accurately measure the $\varnothing D$ for each part and machine hole to provide about 0.005mm (.0002") press fit.

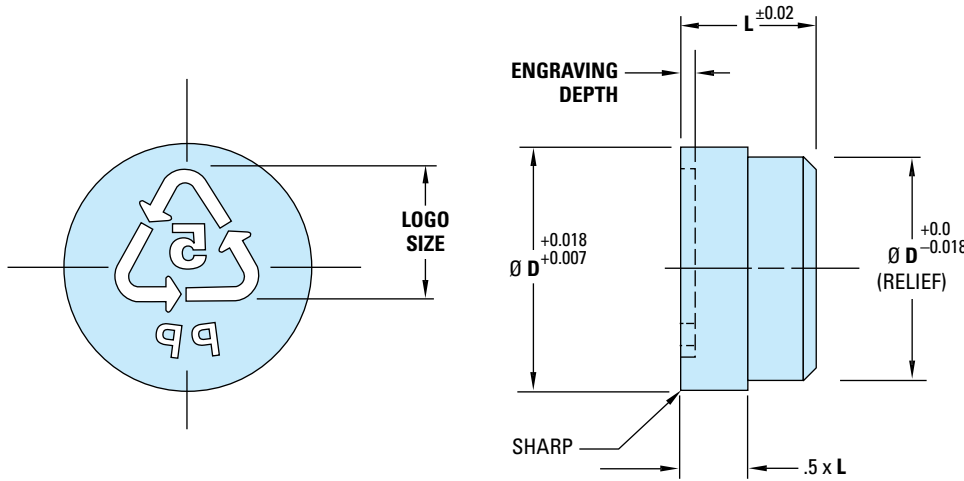

INFORMATION KEY:

D = Outside Diameter
L = Overall Length
Engraving Depth
Logo Size
Material: See chart below
Hardness: See chart below
Dimensions: All dimensions are in mm

Recycling Inserts (Metric) – MRI

ITEM NUMBER	MATERIAL CODES (SPI STANDARD)	MATERIAL	HARDNESS	ENGRAVED LETTERING	MATERIAL IDENTIFICATION	Ø D	L	ENGRAVING DEPTH	LOGO SIZE
MRI 0102	2	420 STAINLESS STEEL	48-52 HRC	HDPE	HIGH DENSITY POLYETHELENE	10	12	0.3	6
MRI 0105	5			PP	POLYPROPYLENE				
MRI 0107	7			OTHER	ALL OTHER RESINS				
MRI 0100	—			ARROW SYMBOL ONLY	—				
MRI 0202	2	7075-7651 ALUMINUM	145-155 BRINELL	HDPE	HIGH DENSITY POLYETHELENE	16	14	0.3	10
MRI 0205	5			PP	POLYPROPYLENE				
MRI 0207	7			OTHER	ALL OTHER RESINS				
MRI 0200	—			ARROW SYMBOL ONLY	—				
MRI 0602	2	7075-7651 ALUMINUM	145-155 BRINELL	HDPE	HIGH DENSITY POLYETHELENE	20	16	0.3	12
MRI 0605	5			PP	POLYPROPYLENE				
MRI 0607	7			OTHER	ALL OTHER RESINS				
MRI 0600	—			ARROW SYMBOL ONLY	—				

NOTE: Additional material codes are available. Contact D-M-E for quote.