

Dowel Pins and Tubular Dowels – Inch

Dowel Pins

D-M-E Dowel Pins are made from high-grade alloy steel, hardened and precision ground.



LENGTH	DIAMETER									LENGTH
	1/8	3/16	1/4	5/16	3/8	1/2	5/8	3/4	1	
3/8	●	—	—	—	—	—	—	—	—	3/8
1/2	●	●	●	—	—	—	—	—	—	1/2
3/4	●	●	●	—	●	●	—	—	—	3/4
1	●	●	●	●	●	●	—	—	—	1
1 1/4	—	—	●	●	●	●	—	—	—	1 1/4
1 1/2	—	●	●	●	●	●	●	—	—	1 1/2
2	●	●	●	●	●	●	●	●	●	2
2 1/2	—	—	●	—	●	●	●	●	—	2 1/2
3	—	—	—	—	●	●	●	●	●	3
4	—	—	—	—	—	●	●	●	●	4
5	—	—	—	—	—	—	●	●	●	5

● = in stock

WHEN ORDERING, PLEASE SPECIFY:
 1. Quantity
 2. Diameter
 3. Length

Tubular Dowels

D-M-E Tubular Dowels are hardened and precision ground. They are used in D-M-E mold base assemblies to accurately align the "B" plate, support plate and the ejector housing.



The use of D-M-E Tubular Dowels allows more room for waterlines by superimposing the dowel pin and cap screw as shown at the right.

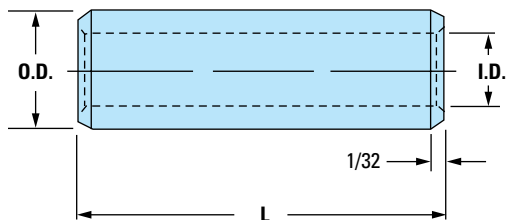

AS USED IN MOLD BASE ASSEMBLIES

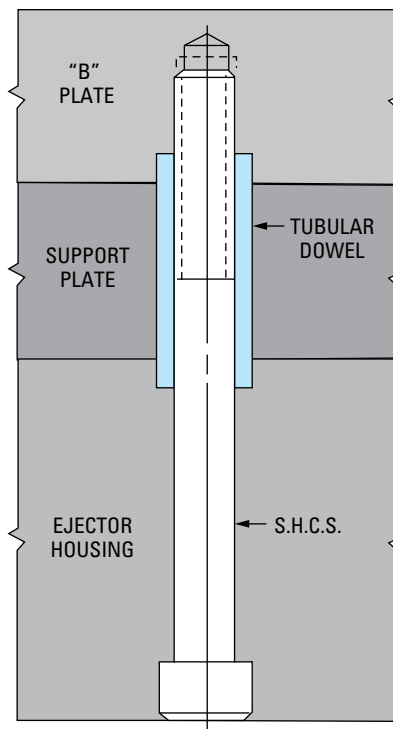

NOM. DIA.	O.D. ±.0002	I.D.	L STANDARD LENGTHS (PRICE EACH)						
			3/8	1/2	7/8	1 3/8	1 7/8	2 3/8	2 7/8
3/8	.3752	.260	●	—	●	—	—	—	—
5/8	.6252	.385	—	●	—	●	●	●	—
3/4	.7502	.510	●	●	—	●	●	●	●
7/8	.8752	.635	—	●	—	—	—	●	●

● = in stock

Tubular Dowels; Washer/Tubular Dowel (Disk for Tubular Dowels) – Metric

Tubular Dowels – R09

Registro tubular | Cavilha tubular | Douaires tubulaires | Paßhülsen

INFORMATION KEY:
D = Outside Diameter
G = Inside Diameter
L = Length
Standard: Euro-Series
Material: 1.7131 (AISI 5115 Type) Steel
Surface Treatment: Case Hardened
Dimensions: Shown in Millimeters (mm)

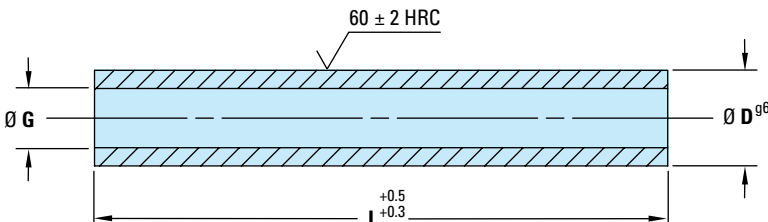

ITEM PREFIX	D	G	L														
			020	030	040	050	060	070	080	100	120	140	160	180	200	240	300
R09	10	6.2			⚡												
	14	8.5															
	18	10.5					⚡		⚡								
	24	13					⚡		⚡		⚡						
	30	17							⚡		⚡		⚡	⚡			

HOW TO ORDER: Specify Item Number with prefix, D diameter and L length. Include zeros as shown, but omit all spaces (spaces are only shown here for easier reading).

Prefix: D: L:

Example: Prefix D L
R09 10 040

Example: Prefix D L
R09 30 180

KEY TO CHART

- Items in stock
- 2-3 week delivery
- Contact D-M-E for quote

Washer/Tubular Dowel (Disk for Tubular Dowels) – R091

Arandela – Registro tubular | Anilhas – para cavilha tubular
 Cachetage cylindrique – Douaires tubulaires | Scheibe – Paßhülsen

INFORMATION KEY:
D = Outside Diameter
G = Inside Diameter
K = Thickness
Standard: Euro-Series
Material: 1.7131 (AISI 5115 Type) Steel
Surface Treatment: Case Hardened
Dimensions: Shown in Millimeters (mm)

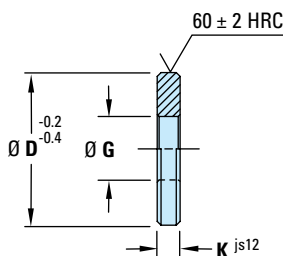

ITEM NUMBER	D	K	G	AVAILABILITY
R091 14 3	14	003	6.2	⚡
R091 18 4	18	004	8.5	⚡
R091 24 5	24	005	10.5	⚡
R091 30 6	30	006	13.0	⚡
R091 40 8	40	008	17.0	⚡

HOW TO ORDER: Specify Item Number. Include zeros as shown, but omit all spaces (spaces are only shown here for easier reading).

Prefix: D: K:

Example: Prefix D K
R091 14 003

Example: Prefix D K
R091 40 008

KEY TO CHART

- Items in stock
- 2-3 week delivery
- Contact D-M-E for quote

Mold Assembly | Tubular Dowels; Washer – Tubular Dowel (Disk) – Metric