

Flat Head Screws – Metric Stop Disk (for Ejector Plates) – Metric

Flat Head Screws – SM

Tornillo de cabeza plana avellanada | Parafusos de cabeça cônica | Vis creuses | Senkkopfschrauben

INFORMATION KEY:
D = Thread Diameter
H = Head Diameter
K = Head Height
L = Length
T = Hex Socket Size (Across Flats)
Standard: DIN 7991-10.9
Material: Per DIN Specification
Dimensions: Shown in Millimeters (mm)

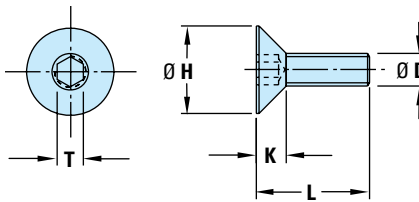

ITEM PREFIX	H	K	T	D	L											
					8	10	12	16	20	25	30	35	40	45	50	
SM3	6	2.5	1.7	M3												
SM4	8	3	2.3	M4	⚡	⚡	⚡									
SM5	10	4	2.8	M5		⚡	⚡	⚡								
SM6	12	5	3.3	M6			⚡	⚡								
SM8	16	6	4.4	M8				⚡	⚡							
SM10	20	8	5.5	M10												
SM12	24	10	6.5	M12												

HOW TO ORDER: Specify Item Number with prefix and L length. Include zeros as shown, but omit all spaces (spaces are only shown here for easier reading).

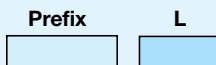

Example:
 Prefix L
 SM3 10

Example:
 Prefix L
 SM8 16

KEY TO CHART

- Items in stock
- 2-3 week delivery
- Contact D-M-E for quote

Stop Disk for Ejector Plates – R18

Arandela de Tople | Anilhas de encosto | Repos d'épaisseur pour plaques d'éjection | Distanzscheibe für Auswerferplatte

INFORMATION KEY:
Standard: Euro-Series
Material: 1.1191 (AISI 1045 Type) Steel
Dimensions: Shown in Millimeters (mm)

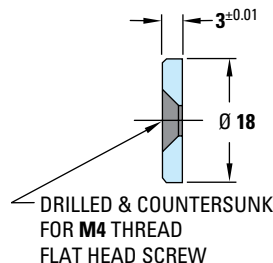

ITEM NUMBER	AVAILABILITY
R18 18	⚡

HOW TO ORDER: Specify Item Number. Omit spaces (spaces are only shown here for easier reading).

Use with SM4 8 Flat Head Screw (M4 thread x 8mm long) which must be purchased separately. See Flat Head Screws above.

KEY TO CHART

- Items in stock
- 2-3 week delivery
- Contact D-M-E for quote