

EXAflow®

EXAflow GmbH & Co. KG Phone +49 (0)6078 7891 - 0 E-Mail info@exaflow.de
Steinschoenauer Str. 4c Fax +49 (0)6078 7891 - 33 Web www.exaflow.de
D - 64823 Gross-Umstadt

Maxiflow - GXK

Technical Information

Available types are GXK-1, GXK-2 and GXK-3.
For bottom (submarine) gating of medium-to-large components. Supports contouring to a depth of 11.5 mm. Suitable for gate diameters up to 3.5 mm and shot weights up to 1,200 per insert.

The Maxiflow range from EXAflow can be used to process all common plastics, including reinforced and brittle types!

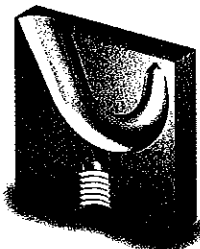

GXK-1

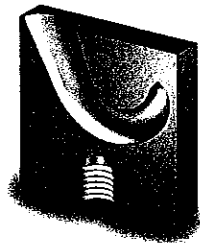
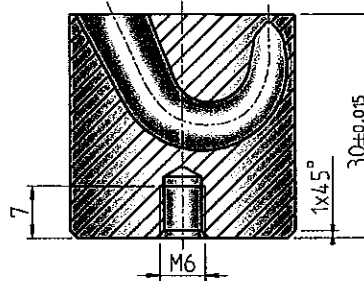
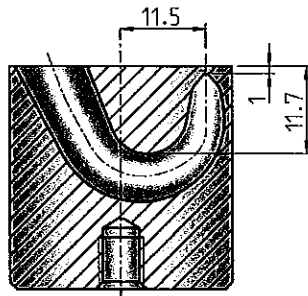

GXK-2

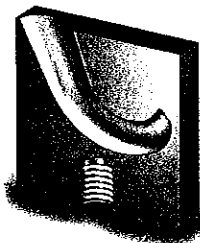
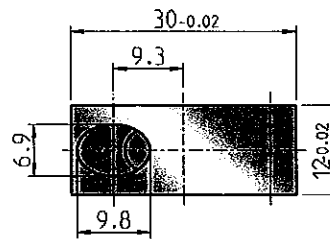
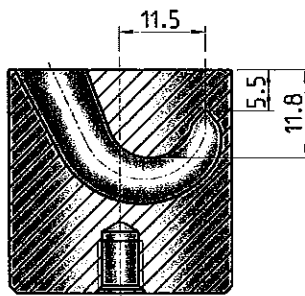

GXK-3

