

# Micro Date Insert

Patented Cumsa System

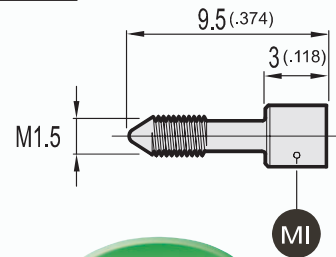

Mat. INOX 1.4034 - Hardened 48/54Rc

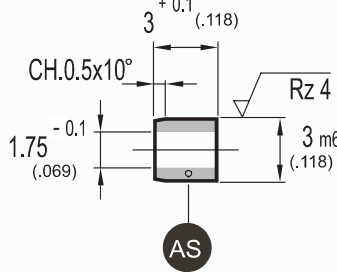
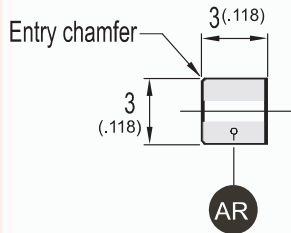
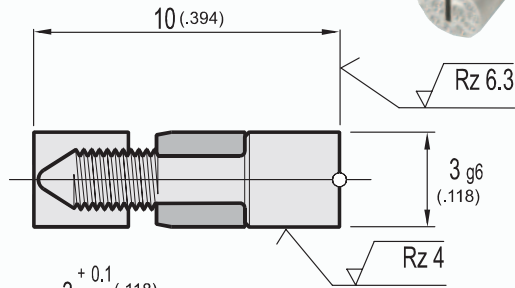

PCS Number

CATALOG NUMBER	INCLUDES
MD 031012	MI, AR, AS, UM
MI 0310-	ONLY REPLACEMENTS

CUMSA Number

CATALOG NUMBER	INCLUDES
FU 031012	IU, AR, AS, UM
IU 0310-	ONLY REPLACEMENTS

When ordering MI, indicate the required year.

- Can be replaced while mold remains in the press.
- Ideal for limited spaces.
- Maximum working temperature 150 °C (300 °F).

## Installation Instructions

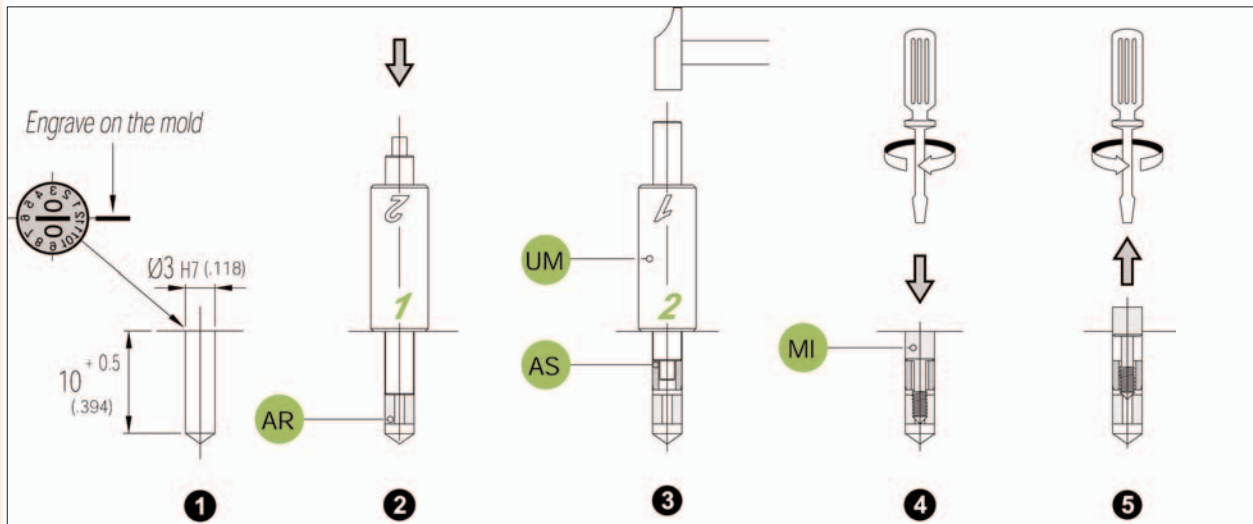

MI Unit Insert      AS Support Unit      AR Retention Ring      UM Installation Tool (Included)

- 1 - Machine pocket and mark reference point or line in cavity.
- 2 - Insert Retention Ring (AR) with installation tool (UM) position (1).
- 3 - Press fit Support Ring (AS) with installation tool (UM) position (2).
- 4 - Screw in the Unit Insert (MI).
- 5 - Unscrew the Unit Insert (MI) to change the year.

Home of the Hardened Throughout™ Pin

