

# Return Pins

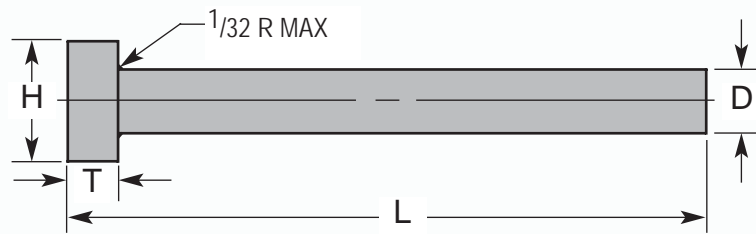

Tolerances	
Pin Diameter (D)	+ .000 - .001
Head Diameter (H)	+ .000 - .010
Head Thickness (T)	+ .000 - .002
Length (L)	+ .013 + .008

- Precision ground premium hotwork steel
- Nitrided 65 - 74 Rc

CATALOG NUMBER	D PIN DIA	H HEAD DIA	T HEAD THICK.	L OVERALL LENGTH
RP-50	.500	.750	.250	3-9/16
RP-51	.500	.750	.250	4-1/16
RP-52	.500	.750	.250	4-9/16
RP-53	.500	.750	.250	5-1/16
RP-54	.500	.750	.250	5-9/16
RP-55	.500	.750	.250	6-1/16
RP-56	.500	.750	.250	6-9/16
RP-60	.625	.875	.250	4-1/16
RP-61	.625	.875	.250	4-9/16
RP-62	.625	.875	.250	5-1/16
RP-63	.625	.875	.250	5-9/16
RP-64	.625	.875	.250	6-1/16
RP-65	.625	.875	.250	6-9/16
RP-66	.625	.875	.250	7-1/16
RP-67	.625	.875	.250	7-9/16
RP-68	.625	.875	.250	8-1/16
RP-70	.750	1.000	.250	4-15/16
RP-71	.750	1.000	.250	5-7/16
RP-72	.750	1.000	.250	5-15/16
RP-73	.750	1.000	.250	6-7/16
RP-74	.750	1.000	.250	6-15/16
RP-75	.750	1.000	.250	7-7/16
RP-76	.750	1.000	.250	7-15/16
RP-77	.750	1.000	.250	8-7/16
RP-78	.750	1.000	.250	8-15/16
RP-79	.750	1.000	.250	9-7/16

