

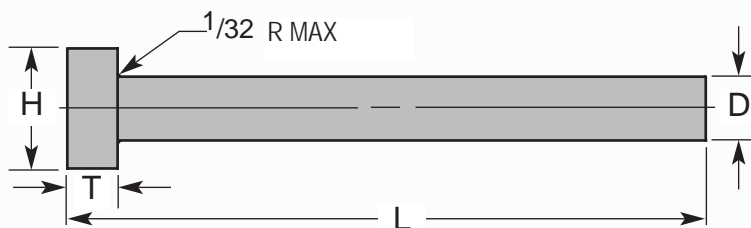

Armor* Pins

The Original

"Hardened Throughout™ Pin" with Armorclad Coating*



What's Important

- **Armorclad® surface treatment reduces wear, friction, and inhibits corrosion.**
- Armorclad* coating will not chip, crack, or peel from base metal
- Enhances metal hardness, adds lubricity
- As-deposited equivalent hardness of 70 - 72 Rc
- Armorclad* coating has a deposited thickness of 0.000050 to 0.000070
- **Etched for Easy Identification**

Tolerances

Pin Diameter (D) AR9 - AR33	+0.0000 -0.0003
Pin Diameter (D) AR37 - AR41	+0.0000 -0.0005
Head Diameter (H)	+0.000 -0.010
Head Thickness (T)	+0.000 -0.002
Length (L)	+0.062 -0.000

Special Size?
Not a Problem!



CATALOG NUMBER	D PIN DIA	+0.0000 -0.0003 ACTUAL SIZE	H HEAD DIA	T HEAD THICK.	L = LENGTH		
					6" STD	10" STD	10" .005 OS
AR9-	1/8	.1245	1/4	1/8	•	•	•
AR11-	5/32	.1557	9/32	5/32	•	•	•
AR13-	3/16	.1870	3/8	3/16	•	•	•
AR15-	7/32	.2183	13/32	3/16	•	•	•
AR17-	1/4	.2495	7/16	3/16	•	•	•
AR21-	5/16	.3120	1/2	1/4	•	•	•
AR25-	3/8	.3745	5/8	1/4	•	•	•
AR33-	1/2	.4995	3/4	1/4	•	•	•
AR37-	5/8	.6245	7/8	1/4	•	•	•
AR41-	3/4	.7495	1	1/4	•	•	•

For oversize pins add "OS" to the end of the catalog number (i.e. AR9-10 OS)

*Armorclad Coating of Michigan.

Home of the Hardened Throughout™ Pin

PCS
COMPANY